

Protection, flexibility and safety

Cam switches from 10 to 200 A

► STANDARD SOLUTIONS P. 124 - 202

The expertise of a specialist like Baco allows us to offer made-to-measure solutions, even the most specific.



Choice of diagram
from 1 to 24 contacts



Metal shaft
can withstand more than
1 million operations

**Customised
engravings**

► ADVANTAGES

- Conform to European and international standards: IEC, UL and CSA, and CCC
- A metal shaft capable of withstanding more than 1 million operations
- More than 50 000 different diagrams available
- Many specific functions and special markings

► MADE-TO-MEASURE SOLUTIONS

How do I order a switch in 5 steps?

Example: A change-over switch without off

- 1 DETERMINE THE RATING** according to the electrical specifications **p. 205**
Voltage, performance, etc (p. 203).
EG: for switching of resistive loads 63A

 - RATING: PR 63
 - PRICE LIST CODE: I
- 2 SELECT A DIAGRAM AND ITS SWITCHING ANGLE** **p. 206**
EG: for a 2 way switch without off, with 1 pole
EG: for a switching angle of 90°

 - CAT. No. 2251
 - PRICE LIST CODE: A02Z
 - CAT. No. A4
 - PRICE LIST CODE: -
- 3 DETERMINE THE MOUNTING METHOD** **p. 239**
front or rear mounting, with screws or on DIN rail.
EG: for rear mounting 68 mm interval

 - CAT. No. S
 - PRICE LIST CODE: Y508
- 4 DEFINE THE PRESENTATION** **p. 253**
Plate, frame and handle, padlockable, with clutch drive, in enclosure,
with key locking, coupling in parallel or in series, dual-voltage device, etc
EG: for a □ 72 frame with a medium handle

 - CAT. No. Q72 MN
 - PRICE LIST CODE: Q72 MN
- 5 SELECT YOUR OPTIONS** **p. 268**
Handles and long handles, legends, legend plate, terminal cover, etc
EG: for a 72 “pump 1 pump 2” engraving

 - engraving
“pump 1 -
pump 2”
 - PRICE LIST CODE: Y000

Example of grid to be used for your order

	Rating	Diagram	Mounting	Presentation	Option 1	Option 2...
DESIGNATION	PR 63	2251 A4	S	Q72 MN	“pump 1 - pump 2”	-
PRICE LIST CODE	I	A02Z -	Y508	Q72 MN	Y000	-
Observations	PR 63 AC21 = 63 A	2 way without off, 1 pole 90° switching angle	Rear mounting	□ 72 plate and frame presentation Medium handle	Duty label Standard engraving	

Cam switches

 Characteristics (p. 203)

► ON-OFF SWITCH

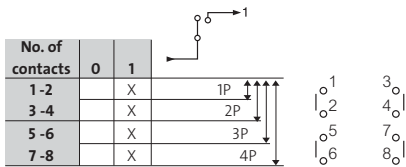

MINI CAM SWITCH - 10 A (AC21)

∅ 16 and 22 single hole front mounting

Cat. No.



223501

30 aluminium plate and frame

- 1P - 1 contact
- 2P - 2 contacts
- 3P - 3 contacts
- 4P - 4 contacts



- 223501**
- 223502**
- 223503**
- 223504**

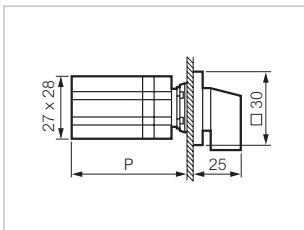

Dimensions in mm
 *P: 50 (1-2 CONTACTS)
 62 (3-4 CONTACTS)

PR 12 - 16 A (AC21)

2 screw panel mount – interval: 30 mm

Cat. No.



NB02AQ1

Designation

Grey/black small handle
 48 aluminium plate and frame

- 1P - 1 contact
- 2P - 2 contacts
- 3P - 3 contacts
- 4P - 4 contacts



- PR12 1101 A4 E Q48PN
- PR12 1102 A4 E Q48PN
- PR12 1103 A4 E Q48PN
- PR12 1104 A4 E Q48PN

- NB01AQ1**
- NB02AQ1**
- NB03AQ1**
- NB04AQ1**

- 1P - 1 contact
- 2P - 2 contacts
- 3P - 3 contacts



- PR12 1101 A8 E Q48PN
- PR12 1102 A8 E Q48PN
- PR12 1103 A8 E Q48PN

- NB01EQ1**
- NB02EQ1**
- NB03EQ1**

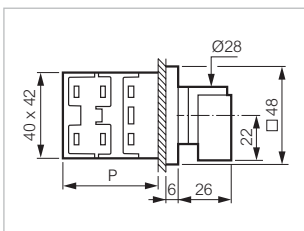

Dimensions in mm
 *P: 36 (1-2 CONTACTS)
 46 (3-4 CONTACTS)

*P = Depth

Cam switches

 Characteristics (p. 203)

► ON-OFF SWITCH (CONTINUED)

PR 12 - 16 A (AC21)

∅ 22 single hole front mounting

Cat. No.



NB03EX80

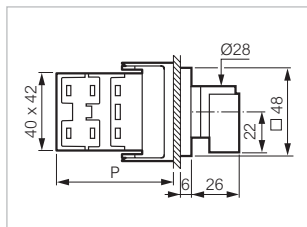

Dimensions in mm
*P: 51 (1-2 CONTACTS)
61 (3-4 CONTACTS)

Grey/black small handle
□ 48 aluminium plate and frame

Designation

- 1P - 1 contact
- 2P - 2 contacts
- 3P - 3 contacts
- 4P - 4 contacts



- PR12 1101 A4 E N48MD50
- PR12 1102 A4 E N48MD50
- PR12 1103 A4 E N48MD50
- PR12 1104 A4 E N48MD50

- NB01AX80**
- NB02AX80**
- NB03AX80
- NB04AX80

- 1P - 1 contact
- 2P - 2 contacts
- 3P - 3 contacts



- PR12 1101 A8 E N48MD50
- PR12 1102 A8 E N48MD50
- PR12 1103 A8 E N48MD50

- NB01EX80**
- NB02EX80**
- NB03EX80**

PR 12 - 16 A (AC21)

∅ 22 single hole front mounting

Cat. No.



NB03AC113

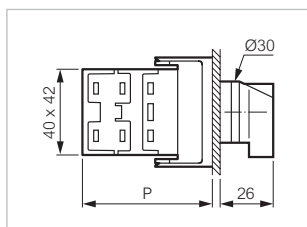

Dimensions in mm
*P: 51 (1-2 CONTACTS)
61 (3-4 CONTACTS)

Selector switch style handle
Matt chrome plastic bezel

Designation

- 1P - 1 contact
- 2P - 2 contacts
- 3P - 3 contacts
- 4P - 4 contacts



- PR12 1101 A4 E C21RA03
- PR12 1102 A4 E C21RA03
- PR12 1103 A4 E C21RA03
- PR12 1104 A4 E C21RA03

- NB01AC113
- NB02AC113
- NB03AC113
- NB04AC113

*P = Depth

Cam switches

 Characteristics (p. 203)

► ON-OFF SWITCH (CONTINUED)

PR 12 - 16 A (AC21)

Enclosure

Cat. No.



NB02AGQ

Grey/black small handle
□ 48 aluminium plate and frame

1P - 1 contact
2P - 2 contacts
3P - 3 contacts
4P - 4 contacts



Designation

PR12 1101 A4 BPRQ48PN
PR12 1102 A4 BPRQ48PN
PR12 1103 A4 BPRQ48PN
PR12 1104 A4 BPRQ48PN

NB01AGQ
NB02AGQ
NB03AHQ
NB04AHQ

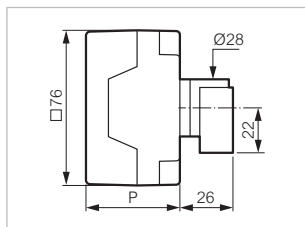

Dimensions in mm

*P: 46 (1-2 CONTACTS)
58 (3-4 CONTACTS)

PR 17 - 20 A (AC21)

2 screw panel mount – interval: 30 mm

Cat. No.



SB04AQ1

Grey/black small handle
□ 48 aluminium plate and frame

1P - 1 contact
2P - 2 contacts
3P - 3 contacts
4P - 4 contacts



Designation

PR17 1101 A4 E Q48PN
PR17 1102 A4 E Q48PN
PR17 1103 A4 E Q48PN
PR17 1104 A4 E Q48PN

SB01AQ1
SB02AQ1
SB03AQ1
SB04AQ1

3P - 3 contacts
4P - 4 contacts



PR17 1103 A8 E Q48PN
PR17 1104 A8 E Q48PN

SB03EQ1
SB04EQ1

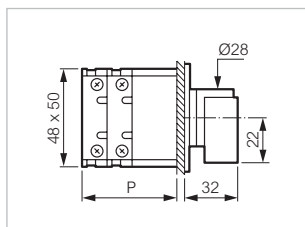

Dimensions in mm

*P: 33 (1-2 CONTACTS)
45 (3-4 CONTACTS)

*P = Depth

Cam switches

 Characteristics (p. 203)

► ON-OFF SWITCH (CONTINUED)

PR 17 -20 A (AC21) **Enclosure** **Cat. No.**



SB02AXQ

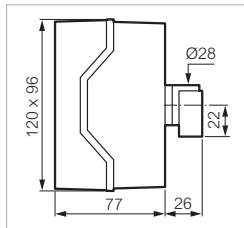

Black small handle
□ 64 aluminium plate and frame

- 1P - 1 contact
- 2P - 2 contacts
- 3P - 3 contacts
- 4P - 4 contacts



Designation

- PR17 1101 A4 BCQ3
- PR17 1102 A4 BCQ3
- PR17 1103 A4 BCQ3
- PR17 1104 A4 BCQ3

- SB01AXQ
- SB02AXQ
- SB03AXQ
- SB04AXQ

PR 21 -25 A (AC21) **2 screw panel mount – interval: 30 mm** **Cat. No.**



TB01AQ1

Grey/black small handle
□ 48 aluminium plate and frame

- 1P - 1 contact
- 2P - 2 contacts
- 3P - 3 contacts
- 4P - 4 contacts



Designation

- PR21 1101 A4 E Q48PN
- PR21 1102 A4 E Q48PN
- PR21 1103 A4 E Q48PN
- PR21 1104 A4 E Q48PN

- TB01AQ1**
- TB02AQ1**
- TB03AQ1**
- TB04AQ1**

- 3P - 3 contacts



- PR21 1103 A8 E Q48PN

- TB03EQ1**

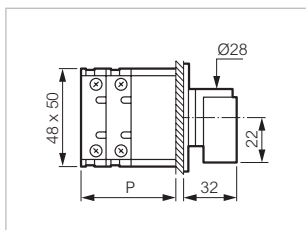

Dimensions in mm
*P: 33 (1-2 CONTACTS)
45 (3-4 CONTACTS)

PR 21 -25 A (AC21) **Enclosure** **Cat. No.**



TB01AXQ

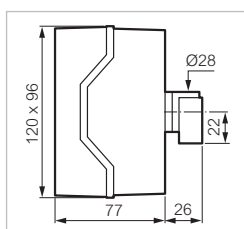

Black small handle
□ 64 aluminium plate and frame

- 1P - 1 contact
- 2P - 2 contacts
- 3P - 3 contacts
- 4P - 4 contacts



Designation

- PR21 1101 A4 BCQ3
- PR21 1102 A4 BQ3
- PR21 1103 A4 BCQ3
- PR21 1104 A4 BCQ3

- TB01AXQ
- TB02AXQ
- TB03AXQ
- TB04AXQ

*P = Depth

Cam switches

 Characteristics (p. 203)

► ON-OFF SWITCH (CONTINUED)

PR 26 -32 A (AC21)

2 screw panel mount – interval: 30 mm

Cat. No.



ZB04AQ7

Designation

Grey/black medium handle
□ 72 aluminium plate and frame

- 1P - 1 contact
- 2P - 2 contacts
- 3P - 3 contacts
- 4P - 4 contacts



- PR26 1101 A4 E Q72MN
- PR26 1102 A4 E Q72MN
- PR26 1103 A4 E Q72MN
- PR26 1104 A4 E Q72MN

- ZB01AQ7**
- ZB02AQ7**
- ZB03AQ7**
- ZB04AQ7**

- 3P -3 contacts



- PR26 1103 A8 E Q72MN

- ZB03EQ7**

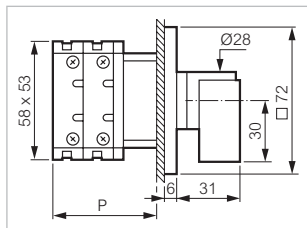

Dimensions in mm
*P: 36 (1-2 CONTACTS)
51 (3-4 CONTACTS)

PR 26 -32 A (AC21)

Enclosure

Cat. No.

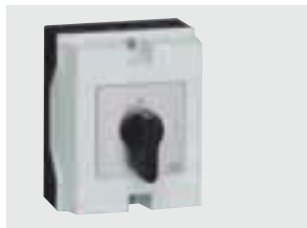

ZB02AXQ

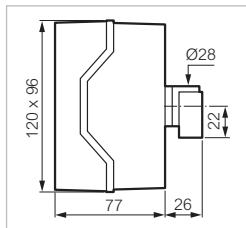

Designation

Black small handle
□ 72 aluminium plate and frame

- 1P - 1 contact
- 2P - 2 contacts
- 3P - 3 contacts
- 4P - 4 contacts



- PR26 1101 A4 BCQ3
- PR26 1102 A4 BCQ3
- PR26 1103 A4 BCQ3
- PR26 1104 A4 BCQ3

- ZB01AXQ**
- ZB02AXQ**
- ZB03AXQ**
- ZB04AXQ**

PR 40 -50 A (AC21)

2 screw panel mount - interval: 50 mm

Cat. No.



HB03AQ7

Designation

Grey/black medium handle
□ 72 aluminium plate and frame

- 1P - 1 contact
- 2P - 2 contacts
- 3P - 3 contacts
- 4P - 4 contacts



- PR40 1101 A4 E Q72MN
- PR40 1102 A4 E Q72MN
- PR40 1103 A4 E Q72MN
- PR40 1104 A4 E Q72MN

- HB01AQ7**
- HB02AQ7**
- HB03AQ7**
- HB04AQ7**

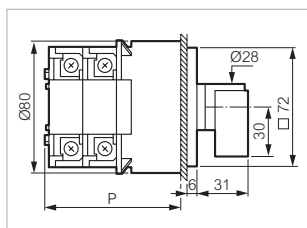

Dimensions in mm
*P: 60 (1-2 CONTACTS)
80 (3-4 CONTACTS)

*P = Depth

Catalogue No. in bold: normally in stock at distribution outlets

Cam switches

 Characteristics (p. 203)

► ON-OFF SWITCH (CONTINUED)

PR 40 -50 A (AC21)

Enclosure

Cat. No.



HB02AAQ

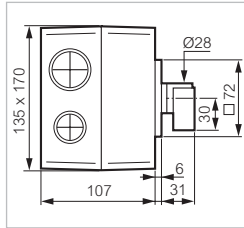

Grey/black medium handle
□ 72 aluminium plate and frame

1P - 1 contact
2P - 2 contacts
3P - 3 contacts
4P - 4 contacts



Designation

PR40 1101 A4 BCFQ72MN
PR40 1102 A4 BCFQ72MN
PR40 1103 A4 BCFQ72MN
PR40 1104 A4 BCFQ72MN

HB01AAQ
HB02AAQ
HB03ABQ
HB04ABQ

PR 63 -63 A (AC21)

2 screw panel mount - interval: 50 mm

Cat. No.



IB03AQ7

Grey/black medium handle
□ 72 aluminium plate and frame

1P - 1 contact
2P - 2 contacts
3P - 3 contacts
4P - 4 contacts



Designation

PR63 1101 A4 E Q72MN
PR63 1102 A4 E Q72MN
PR63 1103 A4 E Q72MN
PR63 1104 A4 E Q72MN

IB01AQ7
IB02AQ7
IB03AQ7
IB04AQ7

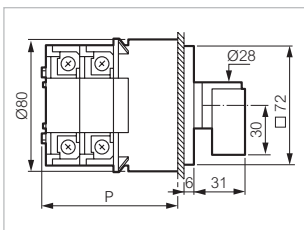

Dimensions in mm

*P: 60 (1-2 CONTACTS)
80 (3-4 CONTACTS)

PR 63 -63 A (AC21)

Enclosure

Cat. No.



IB02AAQ

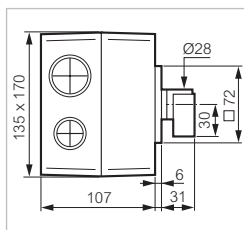

Grey/black medium handle
□ 72 aluminium plate and frame

1P - 1 contact
2P - 2 contacts
3P - 3 contacts
4P - 4 contacts



Designation

PR63 1101 A4 BCF140Q72MN
PR63 1102 A4 BCF140Q72MN
PR63 1103 A4 BCF240Q72MN
PR63 1104 A4 BCF240Q72MN

IB01AAQ
IB02AAQ
IB03ABQ
IB04ABQ

*P = Depth

Cam switches

 Characteristics (p. 203)

► ON-OFF SWITCH (CONTINUED)

PR 125 -160 A (AC21)

2 screw panel mount - interval: 50 mm

Cat. No.



LB02AQ9

Grey/black large handle
□ 96 aluminium plate and frame

Designation

- 1P - 1 contact
- 2P - 2 contacts
- 3P - 3 contacts
- 4P - 4 contacts



- PR125 1101 A4 E Q96GN
- PR125 1102 A4 E Q96GN
- PR125 1103 A4 E Q96GN
- PR125 1104 A4 E Q96GN

- LB01AQ9
- LB02AQ9
- LB03AQ9
- LB04AQ9

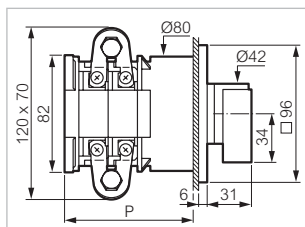

Dimensions in mm
*P: 80 (1-2 CONTACTS)
120 (3-4 CONTACTS)

PR 160 -200 A (AC21)

2 screw panel mount - interval: 50 mm

Cat. No.

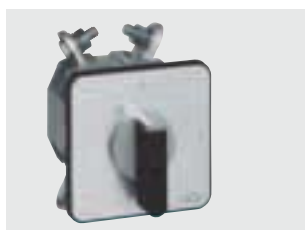

MB02AQ9

Grey/black large handle
□ 96 aluminium plate and frame

Designation

- 1P - 1 contact
- 2P - 2 contacts
- 3P - 3 contacts
- 4P - 4 contacts



- PR160 1101 A4 E Q96GN
- PR160 1102 A4 E Q96GN
- PR160 1103 A4 E Q96GN
- PR160 1104 A4 E Q96GN

- MB01AQ9
- MB02AQ9
- MB03AQ9
- MB04AQ9

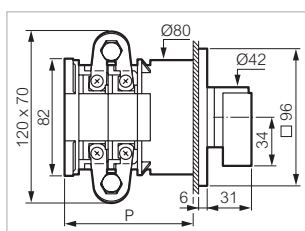

Dimensions in mm
*P: 80 (1-2 CONTACTS)
120 (3-4 CONTACTS)

*P = Depth

Cam switches

 Characteristics (p. 203)

▶ CHANGE-OVER SWITCH WITH “OFF” POSITION

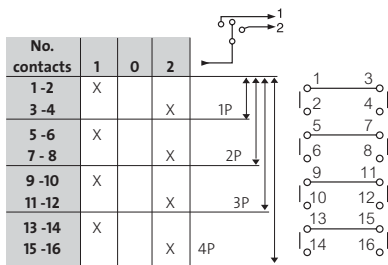

MINI CAM SWITCH - 10 A (AC21)

∅ 16 and ∅ 22 mm single hole front mounting

Cat. No.



223505

30 aluminium plate and frame

- 1P - 2 contacts
- 2P - 4 contacts
- 3P - 6 contacts
- 4P - 8 contacts



223505
223506
223507
223508

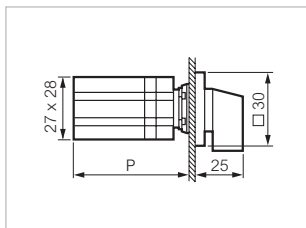

Dimensions in mm

- *P: 50 (1-2 CONTACTS)
- 62 (3-4 CONTACTS)
- 74 (5-6 CONTACTS)
- 96 (7-8 CONTACTS)

PR 12 - 16 A (AC21)

2 screw panel mount – interval: 30 mm

Cat. No.



NC02GQ1

Designation

Grey/black small handle
 48 aluminium plate and frame

- 1P - 2 contacts
- 2P - 4 contacts
- 3P - 6 contacts
- 4P - 8 contacts



PR12 2201 C8 E Q48PN
PR12 2202 C8 E Q48PN
PR12 2203 C8 E Q48PN
PR12 2204 C8 E Q48PN

NC01GQ1
NC02GQ1
NC03GQ1
NC04GQ1

- 1P - 2 contacts
- 2P - 4 contacts
- 3P - 6 contacts



PR12 2201 C4 E Q48PN
PR12 2202 C4 E Q48PN
PR12 2203 C4 E Q48PN

NC01CQ1
NC02CQ1
NC03CQ1

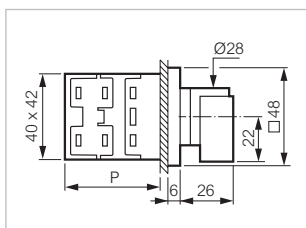

Dimensions in mm

- *P: 36 (1-2 CONTACTS)
- 46 (3-4 CONTACTS)
- 56 (5-6 CONTACTS)
- 66 (7-8 CONTACTS)

*P = Depth

Catalogue No. in bold: normally in stock at distribution outlets

Cam switches

 Characteristics (p. 203)

▶ CHANGE-OVER SWITCH WITH “OFF” POSITION (CONTINUED)

PR 12 - 16 A (AC21)

∅ 22 single hole front mounting

Cat. No.



NC02GX80

Grey/black small handle
□ 48 aluminium plate and frame

Designation

1P - 2 contacts
2P - 4 contacts
3P - 6 contacts
4P - 8 contacts



PR12 2201 C8 E N48MD50
PR12 2202 C8 E N48MD50
PR12 2203 C8 E N48MD50
PR12 2204 C8 E N48MD50

NC01GX80
NC02GX80
NC03GX80
NC04GX80

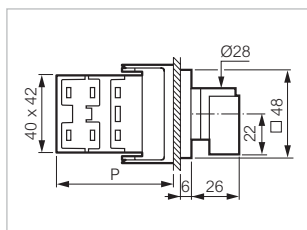

Dimensions in mm

*P: 51 (1-2 CONTACTS)
61 (3-4 CONTACTS)
71 (5-6 CONTACTS)
81 (7-8 CONTACTS)

PR 12 - 16 A (AC21)

∅ 22 single hole front mounting

Cat. No.



NC02GC113

Black handle
Matt chrome plastic bezel

Designation

1P - 2 contacts
2P - 4 contacts
3P - 6 contacts
4P - 8 contacts



PR12 2201 C8 E C21RA03
PR12 2202 C8 E C21RA03
PR12 2203 C8 E C21RA03
PR12 2204 C8 E C21RA03

NC01GC113
NC02GC113
NC03GC113
NC04GC113

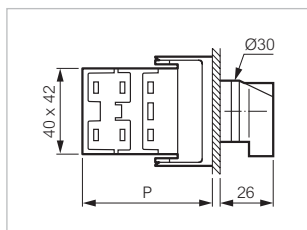

Dimensions in mm

*P: 51 (1-2 CONTACTS)
61 (3-4 CONTACTS)
71 (5-6 CONTACTS)
81 (7-8 CONTACTS)

*P = Depth

Cam switches

 Characteristics (p. 203)

► CHANGE-OVER SWITCH WITH “OFF” POSITION (CONTINUED)

PR 12 - 16 A (AC21)

Enclosure

Cat. No.



NC01GXQ

Black small handle
□ 64 aluminium plate and frame

1P - 2 contacts
2P - 4 contacts
3P - 6 contacts
4P - 8 contacts



Designation

PR12 2201 C8 BCQ3
PR12 2202 C8 BCQ3
PR12 2203 C8 BCQ3
PR12 2204 C8 BCQ3

NC01GXQ
NC02GXQ
NC03GXQ
NC04GXQ

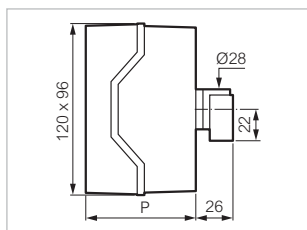

Dimensions in mm
*P: 77 (1 TO 6 CONTACTS)
101 (7-8 CONTACTS)

PR 17 - 20 A (AC21)

2 screw panel mount – interval: 30 mm

Cat. No.



SC04GQ1

Grey/black small handle
□ 48 aluminium plate and frame

1P - 2 contacts
2P - 4 contacts
3P - 6 contacts
4P - 8 contacts



Designation

PR17 2201 C8 E Q48PN
PR17 2202 C8 E Q48PN
PR17 2203 C8 E Q48PN
PR17 2204 C8 E Q48PN

SC01GQ1
SC02GQ1
SC03GQ1
SC04GQ1

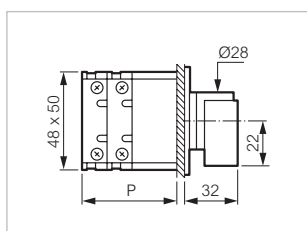

Dimensions in mm
*P: 33 (1-2 CONTACTS)
45 (3-4 CONTACTS)
57 (5-6 CONTACTS)
69 (7-8 CONTACTS)

*P = Depth

Cam switches

 Characteristics (p. 203)

► CHANGE-OVER SWITCH WITH “OFF” POSITION (CONTINUED)

PR 17 - 20 A (AC21)

Enclosure

Cat. No.

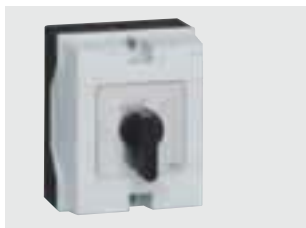

SC01GXQ

Designation

Black small handle
 64 aluminium plate and frame

1P - 2 contacts
 2P - 4 contacts
 3P - 6 contacts
 4P - 8 contacts



PR17 2201 C8 BCQ3
 PR17 2202 C8 BCQ3
 PR17 2203 C8 BCQ3
 PR17 2201 C8 BCQ3

SC01GXQ
 SC02GXQ
 SC03GXQ
 SC04GXQ

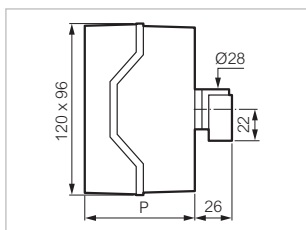

Dimensions in mm
 *P: 77 (1 TO 6 CONTACTS)
 101 (7-8 CONTACTS)

PR 21 - 25 A (AC21)

2 screw panel mount – interval: 30 mm

Cat. No.



TC02GQ1

Designation

Grey/black small handle
 48 aluminium plate and frame

1P - 2 contacts
 2P - 4 contacts
 3P - 6 contacts
 4P - 8 contacts



PR21 2201 C8 E Q48PN
 PR21 2202 C8 E Q48PN
 PR21 2203 C8 E Q48PN
 PR21 2204 C8 E Q48PN

TC01GQ1
 TC02GQ1
 TC03GQ1
 TC04GQ1

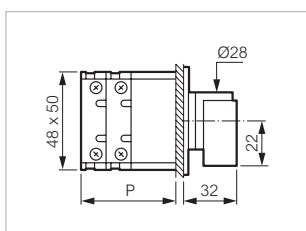

Dimensions in mm
 *P: 33 (1-2 CONTACTS)
 45 (3-4 CONTACTS)
 57 (5-6 CONTACTS)
 69 (7-8 CONTACTS)

*P = Depth

Cam switches

 Characteristics (p. 203)

► CHANGE-OVER SWITCH WITH “OFF” POSITION (CONTINUED)

PR 21 - 25 A (AC21)

Enclosure

Cat. No.



TC03GXQ

Black small handle
 □ 64 aluminium plate and frame

1P - 2 contacts
 2P - 4 contacts
 3P - 6 contacts
 4P - 8 contacts



Designation

PR21 2201 C8 BCQ3
 PR21 2202 C8 BCQ3
 PR21 2203 C8 BCQ3
 PR21 2204 C8 BCQ3

TC01GXQ
TC02GXQ
 TC03GXQ
TC04GXQ

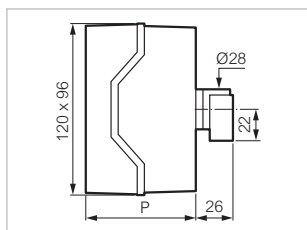

Dimensions in mm
 *P: 77 (1 TO 6 CONTACTS)
 101 (7-8 CONTACTS)

PR 26 - 32 A (AC21)

2 screw panel mount – interval: 30 mm

Cat. No.



ZC02GQ7

Grey/black medium handle
 □ 72 aluminium plate and frame

1P - 2 contacts
 2P - 4 contacts
 3P - 6 contacts
 4P - 8 contacts



Designation

PR26 2201 C8 E Q72MN
 PR26 2202 C8 E Q72MN
 PR26 2203 C8 E Q72MN
 PR26 2204 C8 E Q72MN

ZC01GQ7
ZC02GQ7
 ZC03GQ7
ZC04GQ7

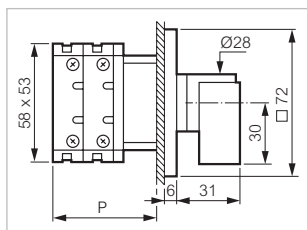

Dimensions in mm
 *P: 36 (1-2 CONTACTS)
 51 (3-4 CONTACTS)
 66 (5-6 CONTACTS)
 81 (7-8 CONTACTS)

*P = Depth

Cam switches

 Characteristics (p. 203)

▶ CHANGE-OVER SWITCH WITH “OFF” POSITION (CONTINUED)

PR 26 - 32 A (AC21)

Enclosure

Cat. No.



ZC04GXQ

Black small handle
□ 64 aluminium plate and frame

1P - 2 contacts
2P - 4 contacts
3P - 6 contacts
4P - 8 contacts



Designation

PR26 2201 C8 BCQ3
PR26 2202 C8 BCQ3
PR26 2203 C8 BCQ3
PR26 2204 C8 BCQ3

ZC01GXQ
ZC02GXQ
ZC03GXQ
ZC04GXQ

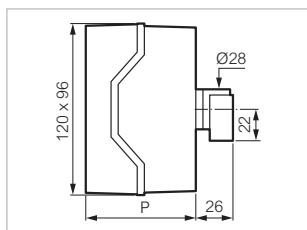

Dimensions in mm
*P: 77 (1 TO 6 CONTACTS)
101 (7-8 CONTACTS)

PR 40 - 50 A (AC21)

2 screw panel mount - interval: 50 mm

Cat. No.



HC03GQ7

Grey/black medium handle
□ 72 aluminium plate and frame

1P - 2 contacts
2P - 4 contacts
3P - 6 contacts
4P - 8 contacts



Designation

PR40 2201 C8 E Q72MN
PR40 2202 C8 E Q72MN
PR40 2203 C8 E Q72MN
PR40 2204 C8 E Q72MN

HC01GQ7
HC02GQ7
HC03GQ7
HC04GQ7

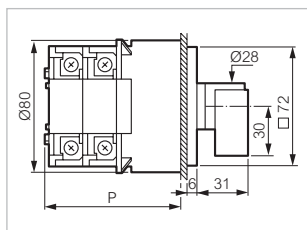

Dimensions in mm
*P: 60 (1-2 CONTACTS)
80 (3-4 CONTACTS)
100 (5-6 CONTACTS)
120 (7-8 CONTACTS)

*P = Depth

Cam switches

 Characteristics (p. 203)

▶ CHANGE-OVER SWITCH WITH “OFF” POSITION (CONTINUED)

PR 40 - 50 A (AC21)

Enclosure

Cat. No.



HC01GAQ

Grey/black medium handle
□ 72 aluminium plate and frame

1P - 2 contacts
2P - 4 contacts
3P - 6 contacts
4P - 8 contacts



Designation

PR40 2201 C8 BCFQ72MN
PR40 2202 C8 BCFQ72MN
PR40 2203 C8 BCFQ72MN
PR40 2204 C8 BCFQ72MN

HC01GAQ
HC02GBQ
HC03GCQ
HC04GDQ

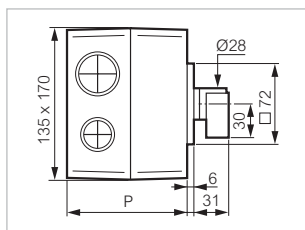

Dimensions in mm

*P: 107 (1 TO 4 CONTACTS)
145 (5 TO 8 CONTACTS)

PR 63 - 63 A (AC21)

2 screw panel mount - interval: 50 mm

Cat. No.



IC02GQ7

Grey/black medium handle
□ 72 aluminium plate and frame

1P - 2 contacts
2P - 4 contacts
3P - 6 contacts
4P - 8 contacts



Designation

PR63 2201 C8 E Q72MN
PR63 2202 C8 E Q72MN
PR63 2203 C8 E Q72MN
PR63 2204 C8 E Q72MN

IC01GQ7
IC02GQ7
IC03GQ7
IC04GQ7

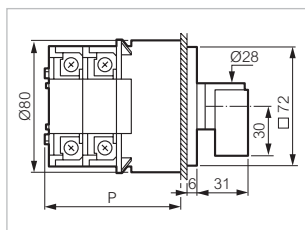

Dimensions in mm

*P: 60 (1-2 CONTACTS)
80 (3-4 CONTACTS)
100 (5-6 CONTACTS)
120 (7-8 CONTACTS)

*P = Depth

Catalogue No. in bold: normally in stock at distribution outlets

Cam switches

 Characteristics (p. 203)

► CHANGE-OVER SWITCH WITH “OFF” POSITION (CONTINUED)

PR 63 - 63 A (AC21)

Enclosure

Cat. No.



IC02GBQ

Grey/black medium handle
□ 72 aluminium plate and frame

1P - 2 contacts
2P - 4 contacts
3P - 6 contacts
4P - 8 contacts



Designation

PR63 2201 C8 BCFQ72MN
PR63 2202 C8 BCFQ72MN
PR63 2203 C8 BCFQ72MN
PR63 2204 C8 BCFQ72MN

IC01GAQ
IC02GBQ
IC03GCQ
IC04GDQ

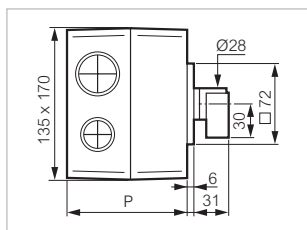

Dimensions in mm

*P: 107 (1 TO 4 CONTACTS)
145 (5 TO 8 CONTACTS)

PR 125 - 160 A (AC21)

2 screw panel mount - interval: 50 mm

Cat. No.



LC02GQ9

Grey/black large handle
□ 96 aluminium plate and frame

1P - 2 contacts
2P - 4 contacts
3P - 6 contacts
4P - 8 contacts



Designation

PR125 2201 C8 E Q96GN
PR125 2202 C8 E Q96GN
PR125 2203 C8 E Q96GN
PR125 2204 C8 E Q96GN

LC01GQ9
LC02GQ9
LC03GQ9
LC04GQ9

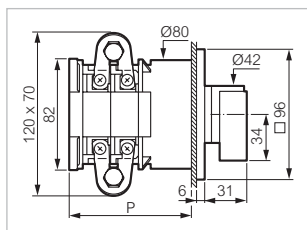

Dimensions in mm

*P: 80 (1-2 CONTACTS)
120 (3-4 CONTACTS)
160 (5-6 CONTACTS)
200 (7-8 CONTACTS)

*P = Depth

Catalogue No. in bold: normally in stock at distribution outlets

Cam switches

 Characteristics (p. 203)

► CHANGE-OVER SWITCH WITH “OFF” POSITION (CONTINUED)

PR 160 - 200 A (AC21)

2 screw panel mount - interval: 50 mm

Cat. No.



MC02GQ9

Grey/black large handle
 96 aluminium plate and frame

- 1P - 2 contacts
- 2P - 4 contacts
- 3P - 6 contacts
- 4P - 8 contacts



Designation

PR160 2201 C8 E Q96GN	MC01GQ9
PR160 2202 C8 E Q96GN	MC02GQ9
PR160 2203 C8 E Q96GN	MC03GQ9
PR160 2204 C8 E Q96GN	MC04GQ9

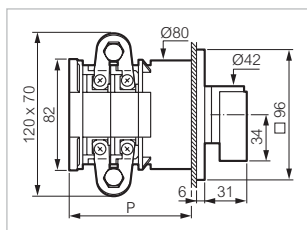

Dimensions in mm

- *P: 80 (1-2 CONTACTS)
- 120 (3-4 CONTACTS)
- 160 (5-6 CONTACTS)
- 200 (7-8 CONTACTS)

*P = Depth

Cam switches

 Characteristics (p. 203)

► CHANGE-OVER SWITCH WITHOUT “OFF” POSITION

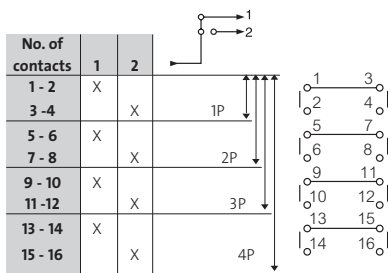

MINI CAM SWITCH - 10 A (AC21)

∅ 16 and ∅ 22 mm single hole front mounting

Cat. No.



223511

30 aluminium plate and frame

- 1P - 2 contacts
- 2P - 4 contacts
- 3P - 6 contacts
- 4P - 8 contacts



- 223511**
- 223512**
- 223513**
- 223514**

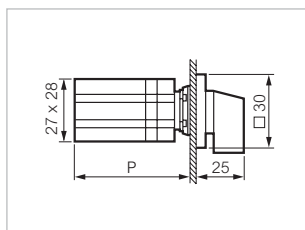

Dimensions in mm

- *P: 50 (1-2 CONTACTS)
- 62 (3-4 CONTACTS)
- 74 (5-6 CONTACTS)
- 86 (7-8 CONTACTS)

PR 12 - 16 A (AC21)

2 screw panel mount – interval: 30 mm

Cat. No.



NC53DQ1

Designation

- Grey/black small handle
- 48 aluminium plate and frame

- 1P - 2 contacts
- 2P - 4 contacts
- 3P - 6 contacts
- 4P - 8 contacts



- PR12 2251 D4 E Q48PN
- PR12 2252 D4 E Q48PN
- PR12 2253 D4 E Q48PN
- PR12 2254 D4 E Q48PN

- NC51DQ1**
- NC51DQ1**
- NC53DQ1**
- NC54DQ1**

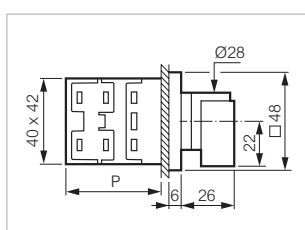

Dimensions in mm

- *P: 36 (1-2 CONTACTS)
- 46 (3-4 CONTACTS)
- 56 (5-6 CONTACTS)
- 66 (7-8 CONTACTS)

*P = Depth

Catalogue No. in bold: normally in stock at distribution outlets

Cam switches

 Characteristics (p. 203)

▶ CHANGE-OVER SWITCH WITH “OFF” POSITION (CONTINUED)

PR 12 - 16 A (AC21)

∅ 22 single hole front mounting

Cat. No.



NC53DX80

Grey/black small handle
□ 48 aluminium plate and frame

Designation

1P - 2 contacts
2P - 4 contacts
3P - 6 contacts
4P - 8 contacts



PR12 2251 D4 E N48MD50
PR12 2252 D4 E N48MD50
PR12 2253 D4 E N48MD50
PR12 2254 D4 E N48MD50

NC51DX80
NC52DX80
NC53DX80
NC54DX80

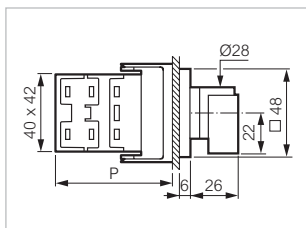

Dimensions in mm

*P: 51 (1-2 CONTACTS)
61 (3-4 CONTACTS)
71 (5-6 CONTACTS)
81 (7-8 CONTACTS)

PR 12 - 16 A (AC21)

Modular in panel DIN rail mounting

Cat. No.



NDF15

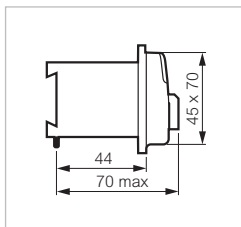

Small grey handle

2P - 4 contacts



Designation

PR12 2202 C8 DF

NDF15

PR 12 - 16 A (AC21)

∅ 22 single hole front mounting

Cat. No.



NC52DC113

Black handle
Matt chrome plastic bezel

1P - 2 contacts
2P - 4 contacts
3P - 6 contacts
4P - 8 contacts



Designation

PR12 2251 D4 E C21RA03
PR12 2252 D4 E C21RA03
PR12 2253 D4 E C21RA03
PR12 2254 D4 E C21RA03

NC51DC113
NC52DC113
NC53DC113
NC54DC113

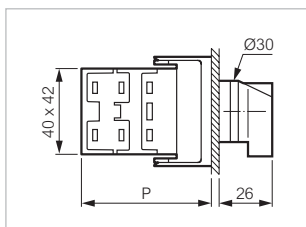

Dimensions in mm

*P: 51 (1-2 CONTACTS)
61 (3-4 CONTACTS)
71 (5-6 CONTACTS)
81 (7-8 CONTACTS)

*P = Depth

Catalogue No. in bold: normally in stock at distribution outlets

Cam switches

 Characteristics (p. 203)

► CHANGE-OVER SWITCH WITH “OFF” POSITION (CONTINUED)

PR 12 - 16 A (AC21)

Enclosure

Cat. No.



NC51DXQ

Black small handle
□ 64 aluminium plate and frame

1P - 2 contacts
2P - 4 contacts
3P - 6 contacts
4P - 8 contacts



Designation

PR12 2251 D4 BCQ3
PR12 2252 D4 BCQ3
PR12 2253 D4 BCQ3
PR12 2254 D4 BCQ3

NC51DXQ
NC52DXQ
NC53DXQ
NC54DXQ

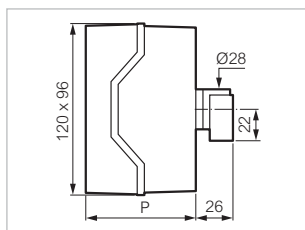

Dimensions in mm
*P: 77 (1 TO 6 CONTACTS)
101 (7 TO 8 CONTACTS)

PR 17 - 20 A (AC21)

2 screw panel mount – interval: 30 mm

Cat. No.



SC52DQ1

Grey/black small handle
□ 48 aluminium plate and frame

1P - 2 contacts
2P - 4 contacts
3P - 6 contacts
4P - 8 contacts



Designation

PR17 2251 D4 E Q48PN
PR17 2252 D4 E Q48PN
PR17 2253 D4 E Q48PN
PR17 2254 D4 E Q48PN

SC51DQ1
SC52DQ1
SC53DQ1
SC54DQ1

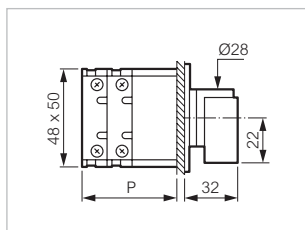

Dimensions in mm
*P: 33 (1-2 CONTACTS)
45 (3-4 CONTACTS)
57 (5-6 CONTACTS)
69 (7-8 CONTACTS)

*P = Depth

Cam switches

 Characteristics (p. 203)

▶ CHANGE-OVER SWITCH WITH “OFF” POSITION (CONTINUED)

PR 17 - 20 A (AC21)

Enclosure

Cat. No.



SC51DXQ

Black small handle
□ 64 aluminium plate and frame

1P - 2 contacts
2P - 4 contacts
3P - 6 contacts
4P - 8 contacts



Designation

PR17 2251 D4 BCQ3
PR17 2252 D4 BCQ3
PR17 2253 D4 BCQ3
PR17 2254 D4 BCQ3

SC51DXQ
SC52DXQ
SC53DXQ
SC54DXQ

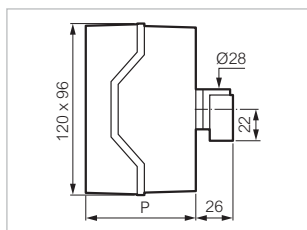

Dimensions in mm
*P: 77 (1 TO 6 CONTACTS)
101 (7 TO 8 CONTACTS)

PR 21 - 25 A (AC21)

2 screw panel mount – interval: 30 mm

Cat. No.



TC51DQ1

Grey/black small handle
□ 48 aluminium plate and frame

1P - 2 contacts
2P - 4 contacts
3P - 6 contacts
4P - 8 contacts



Designation

PR21 2251 D4 E Q48PN
PR21 2252 D4 E Q48PN
PR21 2253 D4 E Q48PN
PR21 2254 D4 E Q48PN

TC51DQ1
TC52DQ1
TC53DQ1
TC54DQ1

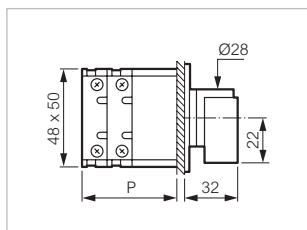

Dimensions in mm
*P: 33 (1-2 CONTACTS)
45 (3-4 CONTACTS)
57 (5-6 CONTACTS)
69 (7-8 CONTACTS)

*P = Depth

Catalogue No. in bold: normally in stock at distribution outlets

Cam switches

 Characteristics (p. 203)

▶ CHANGE-OVER SWITCH WITH “OFF” POSITION (CONTINUED)

PR 21 - 25 A (AC21)

Enclosure

Cat. No.



TC53DXQ

Black small handle
 □ 64 aluminium plate and frame

1P - 2 contacts
 2P - 4 contacts
 3P - 6 contacts
 4P - 8 contacts



Designation

PR21 2251 D4 BCQ3
 PR21 2252 D4 BCQ3
 PR21 2253 D4 BCQ3
 PR21 2254 D4 BCQ3

TC51DXQ
 TC52DXQ
 TC53DXQ
 TC54DXQ

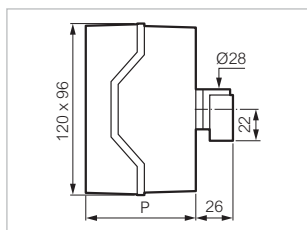

Dimensions in mm
 *P: 77 (1 TO 6 CONTACTS)
 101 (7 TO 8 CONTACTS)

PR 26 - 32 A (AC21)

2 screw panel mount – interval: 30 mm

Cat. No.



ZC52DQ7

Grey/black medium handle
 □ 72 aluminium plate and frame

1P - 2 contacts
 2P - 4 contacts
 3P - 6 contacts
 4P - 8 contacts



Designation

PR26 2251 D4 E Q72MN
 PR26 2252 D4 E Q72MN
 PR26 2253 D4 E Q72MN
 PR26 2254 D4 E Q72MN

ZC51DQ7
ZC52DQ7
 ZC53DQ7
 ZC54DQ7

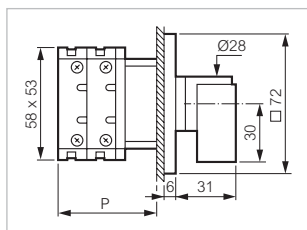

Dimensions in mm
 *P: 36 (1-2 CONTACTS)
 51 (3-4 CONTACTS)
 66 (5-6 CONTACTS)
 81 (7-8 CONTACTS)

*P = Depth

Cam switches

 Characteristics (p. 203)

▶ CHANGE-OVER SWITCH WITH “OFF” POSITION (CONTINUED)

PR 26 - 32 A (AC21)

Enclosure

Cat. No.



ZC51DXQ

Black small handle
□ 64 aluminium plate and frame

1P - 2 contacts
2P - 4 contacts
3P - 6 contacts
4P - 8 contacts



Designation

PR26 2251 D4 BCQ3
PR26 2252 D4 BCQ3
PR26 2253 D4 BCQ3
PR26 2254 D4 BCQ3

ZC51DXQ
ZC52DXQ
ZC53DXQ
ZC54DXQ

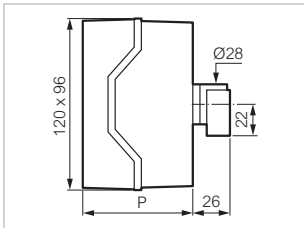

Dimensions in mm
*P: 77 (1 TO 4 CONTACTS)
101 (5 TO 8 CONTACTS)

PR 40 - 50 A (AC21)

2 screw panel mount - interval: 50 mm

Cat. No.



HC52DQ7

Grey/black medium handle
□ 72 aluminium plate and frame

1P - 2 contacts
2P - 4 contacts
3P - 6 contacts
4P - 8 contacts



Designation

PR40 2251 D4 E Q72MN
PR40 2252 D4 E Q72MN
PR40 2253 D4 E Q72MN
PR40 2254 D4 E Q72MN

HC51DQ7
HC52DQ7
HC53DQ7
HC54DQ7

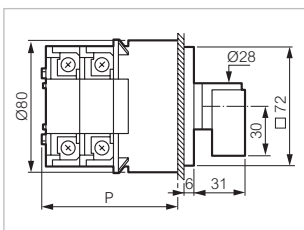

Dimensions in mm
*P: 60 (1-2 CONTACTS)
80 (3-4 CONTACTS)
100 (5-6 CONTACTS)
120 (7-8 CONTACTS)

*P = Depth

Cam switches

 Characteristics (p. 203)

▶ CHANGE-OVER SWITCH WITH “OFF” POSITION (CONTINUED)

PR 40 - 50 A (AC21)

Enclosure

Cat. No.



HC52DBQ

Grey/black medium handle
□ 72 aluminium plate and frame

Designation

1P - 2 contacts
2P - 4 contacts
3P - 6 contacts
4P - 8 contacts



PR40 2251 D4 BCF Q72MN
PR40 2252 D4 BCF Q72MN
PR40 2253 D4 BCF Q72MN
PR40 2254 D4 BCF Q72MN

HC51DAQ
HC52DBQ
HC53DCQ
HC54DDQ

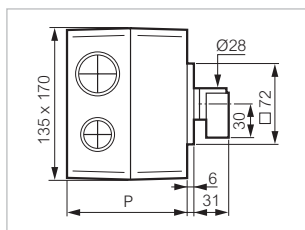

Dimensions in mm
*P: 107 (1 TO 4 CONTACTS)
145 (5 À 8 CONTACTS)

PR 63 - 63 A (AC21)

2 screw panel mount - interval: 50 mm

Cat. No.



IC51DQ7

Grey/black medium handle
□ 72 aluminium plate and frame

Designation

1P - 2 contacts
2P - 4 contacts
3P - 6 contacts
4P - 8 contacts



PR63 2251 D4 E Q72MN
PR63 2252 D4 E Q72MN
PR63 2253 D4 E Q72MN
PR63 2254 D4 E Q72MN

IC51DQ7
IC52DQ7
IC53DQ7
IC54DQ7

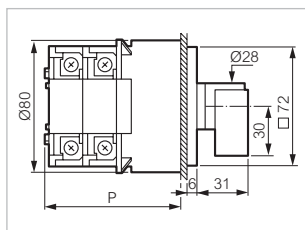

Dimensions in mm
*P: 60 (1-2 CONTACTS)
80 (3-4 CONTACTS)
100 (5-6 CONTACTS)
120 (7-8 CONTACTS)

*P = Depth

Cam switches

 Characteristics (p. 203)

► CHANGE-OVER SWITCH WITH “OFF” POSITION (CONTINUED)

PR 63 - 63 A (AC21)

Enclosure

Cat. No.



IC52DBQ

Grey/black medium handle
□ 72 aluminium plate and frame

1P - 2 contacts
2P - 4 contacts
3P - 6 contacts
4P - 8 contacts



Designation

PR63 2251 D4 BCF Q72MN
PR63 2252 D4 BCF Q72MN
PR63 2253 D4 BCF Q72MN
PR63 2254 D4 BCF Q72MN

IC51DAQ
IC52DBQ
IC53DCQ
IC54DDQ

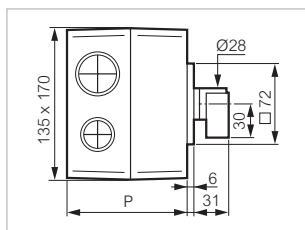

Dimensions in mm
*P: 107 (1 TO 4 CONTACTS)
145 (5 À 8 CONTACTS)

PR 125 - 160 A (AC21)

2 screw panel mount - interval: 50 mm

Cat. No.



LC52DQ9

Grey/black large handle
□ 96 aluminium plate and frame

1P - 2 contacts
2P - 4 contacts
3P - 6 contacts
4P - 8 contacts



Designation

PR125 2251 D4 E Q96GN
PR125 2252 D4 E Q96GN
PR125 2253 D4 E Q96GN
PR125 2254 D4 E Q96GN

LC51DQ9
LC52DQ9
LC53DQ9
LC54DQ9

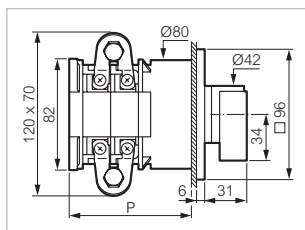

Dimensions in mm
*P: 80 (1-2 CONTACTS)
120 (3-4 CONTACTS)
160 (5-6 CONTACTS)
200 (7-8 CONTACTS)

*P = Depth

Cam switches

 Characteristics (p. 203)

► CHANGE-OVER SWITCH WITH “OFF” POSITION (CONTINUED)

PR 160 - 200 A (AC21)

2 screw panel mount - interval: 50 mm

Cat. No.



MC52DQ9

Grey/black large handle
 96 aluminium plate and frame

1P - 2 contacts
 2P - 4 contacts
 3P - 6 contacts
 4P - 8 contacts



Designation

PR160 2251 D4 E Q96GN
 PR160 2252 D4 E Q96GN
 PR160 2253 D4 E Q96GN
 PR160 2254 D4 E Q96GN

MC51DQ9
 MC52DQ9
 MC53DQ9
 MC54DQ9

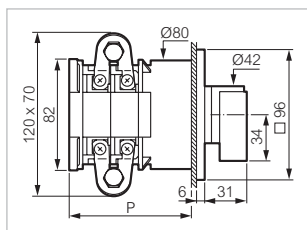

Dimensions in mm

*P: 80 (1-2 CONTACTS)
 120 (3-4 CONTACTS)
 160 (5-6 CONTACTS)
 200 (7-8 CONTACTS)

*P = Depth