

TECHNICAL DATA

Speed Range (load)  
7.5rpm – 335rpm

Rated Voltage – 24v DC  
Operating voltage 8–26v DC

Motor – 3640 Brushless

Current @ max. efficiency  
0.54Amps

Input Power @ max. efficiency  
9 Watts

Output Torque Range  
4.3Nm – 19Nm

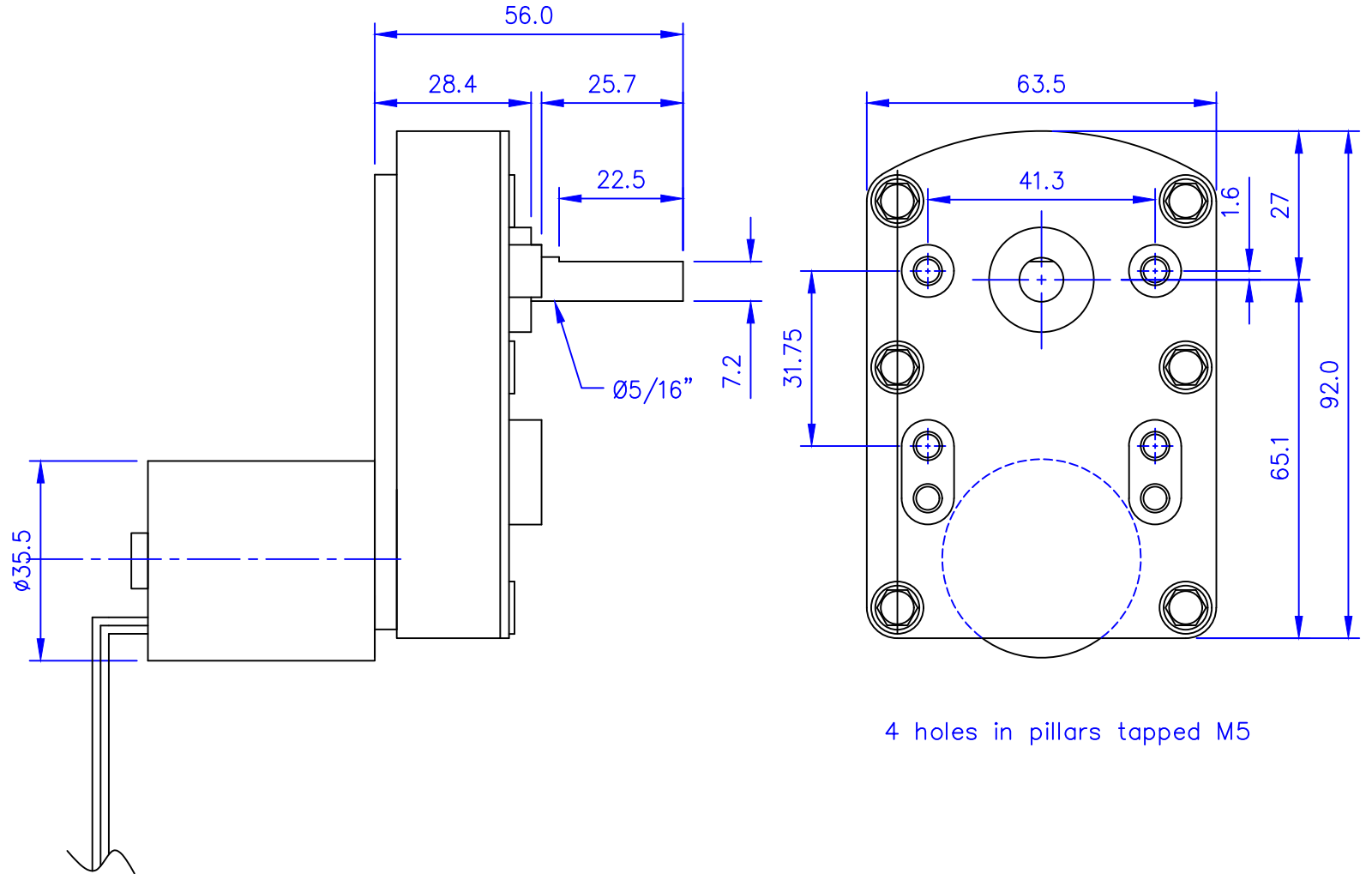
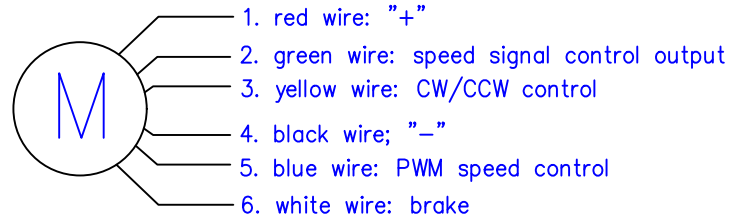

4 holes in pillars tapped M5

Dimensions in mm

MELLOR ELECTRICS Ltd BLACKBURN ENGLAND	APPROVED	-	-	CUSTOMER	SOFTING ITALIA
	DRAWN	LC	02/01/18	DESCRIPTION	T6 24v BRUSHLESS DC GEARBOX
					PART No UBBSERIES