

K35-TYPE

Planetary GEARHEAD

DIMENSIONS

K35-3640 BLDC SERIES

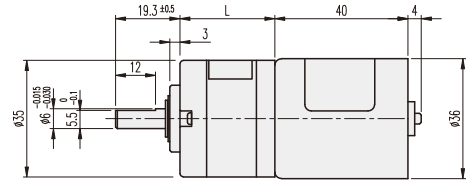
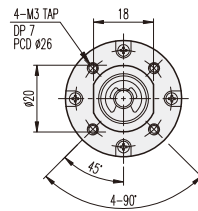

GEARHEAD LENGTH

RATIO	L
1/005	22.1
1/014 ~ 1/027	28.5
1/051 ~ 1/139	34.9
1/189 ~ 1/721	41.3

BLDC MOTOR PERFORMANCE DATA

MODEL	ITEM	VOLTAGE (DC)	NO LOAD		AT MAX. EFF.			WEIGHT (g)
			mA	rpm	gf-cm	A	rpm	
KB3640S1		12V	500	5300	150	1.2	4500	150
KB3640S2		24V	300	5000	250	0.8	3900	

AT MAXIMUM EFFICIENCY (K35-□□□□-KB3640S□)

GEAR	MODEL	KB3640S1		KB3640S2	
		DC 12V		DC 24V	
		rpm	kgf-cm	rpm	kgf-cm
1/0005		900	0.7	780	1.1
1/0014		321	1.7	278	2.9
1/0019		237	2.3	205	3.9
1/0027		167	3.3	144	5.6
1/0051		88	5.5	76	9.5
1/0071		63	7.7	55	12
1/0100		45	10.8	39	12
1/0139		32	12	28	12
1/0189		24	12	21	12
1/0264		17	12	15	12
1/0369		12	12	10.5	12
1/0516		8.7	12	7.6	12
1/0721		6.2	12	5.4	12

- * Gearbox output shaft rotation direction is same direction with motor.
- * Proceed function change in motor stop type.
- * Controller for speed control is GUN type.

How to connect when speed control is not needed.

No - Color	Pin - Contents	Connection Method
1 - White	Brake	No Use, (-) connectin Brake
2 - Blue	PWM	connecting to (-) power
3 - Yellow	1FG(6P/R)	No Use
4 - Orange	CW/CCW	Normal Open, CCW connecting to (-) power
5 - Black	GND	connecting to (-) power
6 - Red	24V	connecting to (+) power

* Please be cautious that Motor can be damaged when connected to incorrect power (+) (-).

