

AM-22P Series

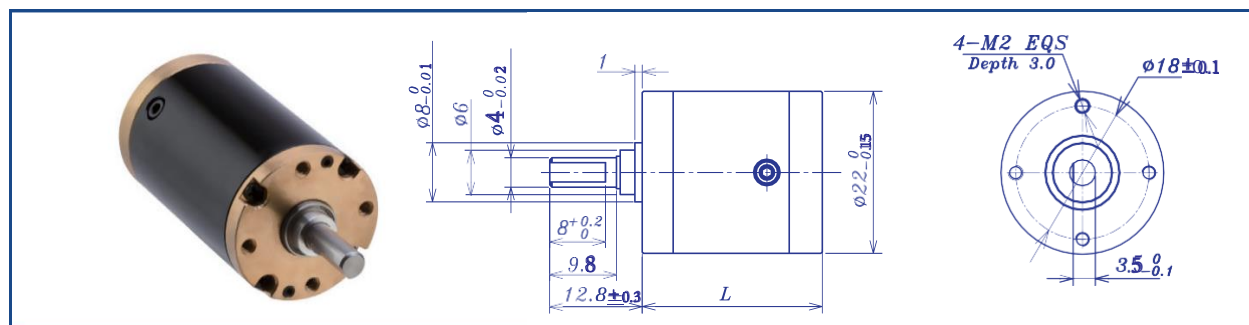

Gear type	Straight teeth	Average backlash on load	$\leq 2^\circ$
Output shaft	Stainless steel hardened	Radial Play	≤ 0.1
Main gear	Alloy Steel	Permissible axial load	$\leq 40N$
Ring gear	Steel	Permissible force press fits	$\leq 100N$ (5mm from mounting face)
Adapter plate	Copper	Recommended input speed	$\leq 10000RPM$
Bearing AT output	Ball bearing	Operating temperature range	$-20^\circ C \sim +50^\circ C$
Axial play	0-0.3	Operating humidity range	10-90%RH
Directions	CW/CCW		

GEARBOX DATA							
Number of stage	1	2	3	4	5		
Reduction ratio X:1	3.3	11 19	37 62 97	175 370 591	742 1996		
	3.8	12 20	41 64 104	198 410 690	1014 2458		
	4.4	14 24	47 72 109	231 455 850	1185 3027		
	5.4	16 29	53 76 128	270 522	1386 3728		
	18	84 158	316 561	1621 4592			
Reduction ratio absolute	63/19	3249/169	250049/6859	1215/16	21625/1216	6561/16	759375/1024
	15/4	81/4	59635/1444	185193/2197	50625/256	5000/211/10985	10965375/10816
	57/13	1539/65	3375/64	45927/475	192375/832	1240029/2375	41668425/35152
	27/5	729/25	14175/304	87723/845	731025/2704	2368521/4225	158340015/114244
			12825/208	2187/20	2777895/8788	59049/100	601692057/371293
		204687/3211	41553/325	10556001/28561	1121931/625	285012027/142805	135005697/54925
		48735/676	19683/125		531441/625	63950067/21125	30292137/8125
							14348907/3125
Gearbox length "L" (mm)	22.3	27.3	32.3	37.3	42.6		
Max. continuous torque (N.m)	0.6	0.8	1	1.2	1.2		
Max. intermitten torque (N.m)	0.9	1.2	1.5	1.8	1.8		
Gearbox efficiency	90%	81%	72%	65%	59%		
Moment of inertia range (g.cm ²)	0.5	0.4	0.5	0.4	0.5		
Gearbox weight approx (g)	56	68	82	92	103		
Gearbox model	AM-22PA-X-01	AM-22PB-X-01	AM-22PC-X-01	AM-22PD-X-01	AM-22PE-X-01		

AM-22P Example of combination

INPUT GEARBOX DATA	
Modulus	0.35
Press angle	20°
Teeth number	10 13 16 19
Max gear hole "A"	2.0 3.0
Max motor shaft	2.0 3.0
Motor dimension "D"	6.15 8.0

MOTOR DIMENSION	
Pinion	2.0
Motor dimension "D"	$\phi 12.0$
Motor shaft	$\phi 2.0$
Motor shaft	$\phi 3.0$
Motor shaft	$2 - M2.0$
Motor shaft	$2.3_{-0.15}$

GEARBOX MOTOR LENGTH "LT"					
Gear motor length L_T	66.5	80.0	80.3	101	
Gearbox length L_1	22.3	27.3	32.3	37.3	
Motor length L_2	32.2	42	40	53	
Encoder length L_3	12	10.7	12	10.7	

Recommend Motor:	Recommend Encoder:
	Suitable for Coreless Motor Encoder S: AM-EN2211S***
Coreless Motor (w/E): AM-CL2232MAN AM-CL2232GAN AM-CL2242MAN AM-CL2242GAN	Suitable for Brushless Motor Encoder S: AM-EN1611S***
	Encoder T: AM-EN1612T***
Brushless Motor (w/E): AM-BL2040AN AM-BL2453AN	