

SERIE NH

NH SERIES | SÉRIE NH

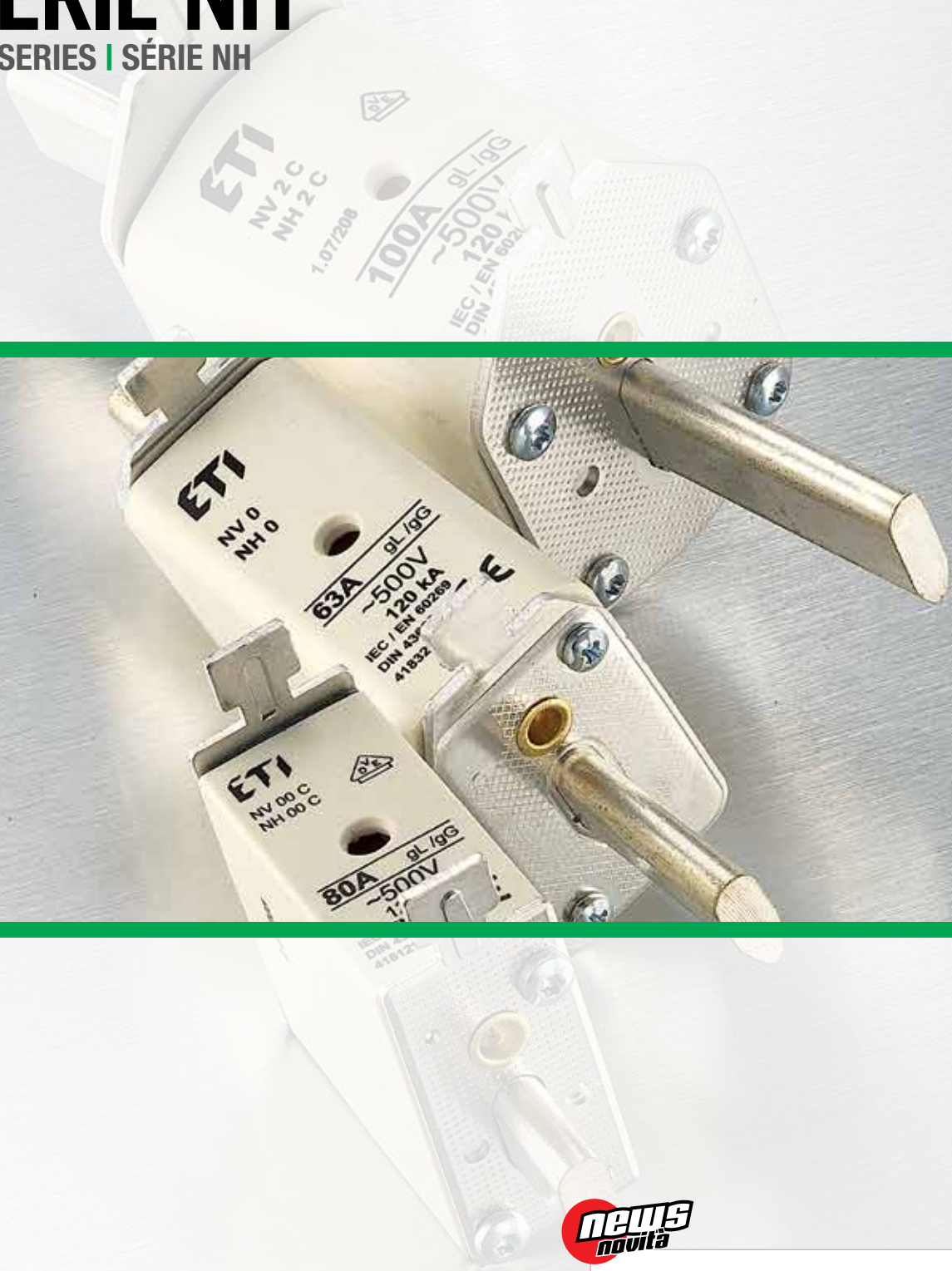

PARTNERS



FUSIBILI NH4aM

NH4aM fuses
Fusibles NH4aM

pag. 47

BASE NH MODULARE

NH modular bases
Bases modulaires NH

pag. 48-49



INDICE Index | Index

FUSIBILI NH gG-gL

NH gG-gL fuses | *Fusibles NH gG-gL*



FUSIBILI NH gG-gL 660V

NH gG-gL 660V fuses | *Fusibles NH gG-gL 660V*



FUSIBILI NH aM

NH aM fuses | *Fusibles NH aM*



BASI UNIPOLARI

Single-pole fuse bases | *Bases unipolaires*



BASI TRIPOLARI

Three-pole fuse bases | *Bases tripolaires*



ACCESSORI

Accessories | *Accessoires*



SEGNALATORI DI FUSIONE

Blowing indicators | *Indicateurs de fusion*



FUSIBILI NH SPECIALI

NH special fuses | *Fusibles NH spéciaux*



INFORMAZIONI GENERALI General Information | Informations Générales

■ FUSIBILI NH gL-gG

I fusibili NH sono la più affidabile ed economica protezione per linee e installazioni elettriche contro piccoli sovraccarichi di corrente e corto circuiti di elevata intensità. Per la tensione nominale di 500V è stata raggiunta la capacità di rottura di 120kA, mentre per la tensione nominale di 660V, la capacità di rottura è di 100kA. I valori standard di corrente nominale vanno da 2A (NH00C) a 1250A (NH4a). La linea dei cavi è protetta al meglio dal fusibile gL-gG. L'intervento del fusibile in caso di un piccolo sovraccarico è lento, ma è molto rapida in caso di corto circuito. In seguito a test di verifica regolarmente ripetuti, le caratteristiche di fusione si sono dimostrate eccezionalmente stabili e la tolleranza sull'asse della corrente è entro $\pm 10\%$. La selettività è garantita in relazione alla corrente nominale nella proporzione di 1:1.6, sia in caso di sovraccarico che in caso di corto circuito.

■ FUSIBILI NH aM

I fusibili con caratteristiche aM sono progettati per la protezione di apparecchiature di controllo così come per la protezione dei motori di azionamenti motorizzati, dove le caratteristiche gL o gG non soddisfano tutte le esigenze per una protezione adeguata di questi dispositivi. Sono prodotti in tutte le misure NH convenzionali, in tutti gli amperaggi e in tutti i voltaggi standard fino a 660V. Il loro compito principale è di rendere possibile l'utilizzo completo delle apparecchiature di controllo dove ci siano delle correnti di avviamento, di evitare la produzione di scintille e danneggiamento dei contatti di protezione in caso di corto circuito. Bisogna sottolineare che questi fusibili sono progettati solo per la protezione di aree limitate (aree di correnti di corto circuito).

■ NH FUSELINKS gL-gG

NH Fuselinks are used as the most reliable and economical protection of cable lines and installation lines against small overloads of current and high short-circuits. At rated voltage of 500V, the breaking capacity is 120kA, and at rated voltage of 660V, the breaking capacity is 100kA. The standard rated currents extend from 2A (NH00 C) to 1250 (NH4a). The cable line is optimally protected by gL-gG fuse link. In case of small overloads the operating time of the fuse link is longer, but in case of a short circuit it is very quick. Cyclic tests have proved that fuse links melting characteristics are very stable and tolerance on the current axis can be up to $\pm 10\%$. Selectivity is assured in rated current proportion 1:1.6 both in case of overloads and short circuits.

■ NH aM FUSELINKS

aM Fuselinks are designed for switchgears and controlgears protection as well as motors in motor drives where gL or gG Fuse links' characteristics do not comply with all the requirements for a successful protection of these devices. They are produced in all NH standard sizes for all standard amperages and for voltages up to 660V. Their main purpose is to allow the full utilization of switchgears and controlgears where starting currents can occur, and prevent sparking and damages to the protective contacts in case of short circuit. It must be noted that this type of fuse links are exclusively designed for the protection of small areas subjected to short circuits.

■ FUSIBLES NH gL-gG

Les fusibles NH représentent la protection la plus fiable et la plus économique pour des lignes et des installations électriques contre les petites surcharges de courant et les courts-circuits d'intensité élevée. Pour la tension nominale de 500V, on atteint le pouvoir de coupure de 120 KA, alors que pour la tension nominale de 660V, le pouvoir de coupure est de 100KA. Les valeurs standards de courant nominal vont de 2A (NH00C) à 1250A (NH4a). La ligne des câbles est protégée au mieux par le fusible gL-gG. L'intervention du fusible en cas d'une petite surcharge est lente, mais elle est très rapide en cas de court-circuit. A la suite de tests de vérification répétés régulièrement, les caractéristiques de fusion se sont révélées exceptionnellement stables et la tolérance sur l'axe du courant est $\pm 10\%$ maximum. La sélectivité est garantie en relation avec le courant nominal dans la proportion de 1:1.6, en cas de surcharge et de court-circuit.

■ FUSIBLES NH aM

Les fusibles avec des caractéristiques aM sont conçus pour la protection des appareils de contrôle et des moteurs à mouvements motorisés, où les caractéristiques gL ou gG ne satisfont pas toutes les exigences d'une protection adaptée pour ces dispositifs. Ils sont produits dans toutes les tailles NH conventionnelles, tous les ampérages et voltages standards jusqu'à 660V. Leur tâche principale est de rendre possible l'utilisation complète des appareils de contrôle où il y a des courants de démarrage/mise en route, d'éviter la production d'étincelles et l'endommagement des contacts de protection en cas de court-circuit. Il faut souligner que ces fusibles sont conçus seulement pour la protection des zones limitées (zones des courants de court-circuit).

SERIE NH

NH series | Série NH



FUSIBILI NH00 gL-gG KOMBI CON DOPPIO INDICATORE

Kombi NH00 gL-gG fuses with double indicator | Fusibles NH00 gL-gG kombi avec double indicateur

Tensione 500 V	Voltage 500 V	Tension 500 V
Potere di interruzione 120 KA	Breaking capacity 120 KA	Pouvoir de coupure 120 KA
Norme riferimento DIN VDE0636-201(1998-06) IEC 60269-1:2005 EN 60269-1:1998+A1:2005 IEC 60269-2:1986+Corr.1:1996 +A11995+A2:2001 EN 60269-2:1995+A1:1998+A2:2002 IEC 60269-2-1:2004 HD 60269-2-1:2005 DIN43620 Parts 1 of 4	Standards DIN VDE0636-201(1998-06) IEC 60269-1:2005 EN 60269-1:1998+A1:2005 IEC 60269-2:1986+Corr.1:1996 +A11995+A2:2001 EN 60269-2:1995+A1:1998+A2:2002 IEC 60269-2-1:2004 HD 60269-2-1:2005 DIN43620 Parts 1 of 4	Normes DIN VDE0636-201(1998-06) IEC 60269-1:2005 EN 60269-1:1998+A1:2005 IEC 60269-2:1986+Corr.1:1996 +A11995+A2:2001 EN 60269-2:1995+A1:1998+A2:2002 IEC 60269-2-1:2004 HD 60269-2-1:2005 DIN43620 Parts 1 of 4
Classe di isolamento C - VDE 0110	Insulating class C - VDE 0110	Classe d'isolation C - VDE 0110

pag. 54-57



Corrente nominale Rated current Courant nominal	Codice Code Code	Pot. dissipata Power loss Puiss. dissipée	I ² t I ² t I ² t	Peso g. Weight Poids g.	
2 A	NH00G002	0,5	-	125	3/120
4 A	NH00G004	0,6	-	125	3/120
6 A	NH00G006	0,8	92	125	3/120
10 A	NH00G010	1,1	236	125	3/120
16 A	NH00G016	1,5	1090	125	3/120
20 A	NH00G020	1,7	1180	125	3/120
25 A	NH00G025	1,8	2600	125	3/120
32 A	NH00G032	-	3780	125	3/120
35 A	NH00G035	2,7	6300	125	3/120
40 A	NH00G040	3,3	6700	125	3/120
50 A	NH00G050	3,0	10500	125	3/120
63 A	NH00G063	3,6	21000	125	3/120
80 A	NH00G080	4,6	35000	125	3/120
100 A	NH00G100	5,4	46800	125	3/120
125 A	NH00G125	6,8	70000	173	3/90
160 A	NH00G160	8,3	122000	173	3/90

Isolati Isulated Isolés					
2 A	NH100G002	0,5	-	125	3/120
4 A	NH100G004	0,6	-	125	3/120
6 A	NH100G006	0,8	92	125	3/120
10 A	NH100G010	1,1	236	125	3/120
16 A	NH100G016	1,5	1090	125	3/120
20 A	NH100G020	1,7	1180	125	3/120
25 A	NH100G025	1,8	2600	125	3/120
32 A	NH100G032	-	3780	125	3/120
35 A	NH100G035	2,7	6300	125	3/120
40 A	NH100G040	3,3	6700	125	3/120
50 A	NH100G050	3,0	10500	125	3/120
63 A	NH100G063	3,6	21000	125	3/120
80 A	NH100G080	4,6	35000	125	3/120
100 A	NH100G100	5,4	46800	125	3/120
125 A	NH100G125	6,8	70000	173	3/90
160 A	NH100G160	8,3	122000	173	3/90

pronta
in stock
en stock



2= 100 A versione NH00C - 125=160 A versione NH00
2= 100 A version NH00C - 125=160 A version NH00
2= 100 A version NH00C - 125=160 A version NH00



FUSIBILI NH0 gL-gG KOMBI CON DOPPIO INDICATORE

Kombi NH0 gL-gG fuses with double indicator | Fusibles NH0 gL-gG kombi avec double indicateur

Tensione 500 V	Voltage 500 V	Tension 500 V
Potere di interruzione 120 KA	Breaking capacity 120 KA	Pouvoir de coupure 120 KA
Norme riferimento DIN VDE0636-201(1998-06) IEC 60269-1:2005 EN 60269-1:1998+A1:2005 IEC 60269-2:1986+Corr.1:1996 +A11995+A2:2001 EN 60269-2:1995+A1:1998+A2:2002 IEC 60269-2-1:2004 HD 60269-2-1:2005 DIN43620 Parts 1 of 4	Standards DIN VDE0636-201(1998-06) IEC 60269-1:2005 EN 60269-1:1998+A1:2005 IEC 60269-2:1986+Corr.1:1996 +A11995+A2:2001 EN 60269-2:1995+A1:1998+A2:2002 IEC 60269-2-1:2004 HD 60269-2-1:2005 DIN43620 Parts 1 of 4	Normes DIN VDE0636-201(1998-06) IEC 60269-1:2005 EN 60269-1:1998+A1:2005 IEC 60269-2:1986+Corr.1:1996 +A11995+A2:2001 EN 60269-2:1995+A1:1998+A2:2002 IEC 60269-2-1:2004 HD 60269-2-1:2005 DIN43620 Parts 1 of 4
Classe di isolamento C - VDE 0110	Insulating class C - VDE 0110	Classe d'isolation C - VDE 0110

pag. 54-57



Corrente nominale Rated current Courant nominal	Codice Code Code	Pot. dissipata Power loss Puiss. dissipée	I ² t I ² t I ² t	Peso g. Weight Poids g.
6 A	NH0G006	1,6	92	226
10 A	NH0G010	1,2	236	226
16 A	NH0G016	1,9	1090	226
20 A	NH0G020	2,1	1180	226
25 A	NH0G025	2,8	2600	226
32 A	NH0G032	3,1	3780	226
35 A	NH0G035	-	6300	226
40 A	NH0G040	4,1	6700	226
50 A	NH0G050	5,6	10500	226
63 A	NH0G063	5,9	21000	226
80 A	NH0G080	6,7	35000	226
100 A	NH0G100	8,1	46800	226
125 A	NH0G125	10,8	70000	226
160 A	NH0G160	12,3	122000	226

3/45 pz
3/45 pcs
3/45 pces

pronta
in stock
en stock

SERIE NH
NH series | Série NH



FUSIBILI NH1 gL-gG KOMBİ CON DOPPIO INDICATORE
Kombi NH1 gL-gG fuses with double indicator | Fusibles NH1 gL-gG kombi avec double indicateur

Tensione 500 V	Voltage 500 V	Tension 500 V
Potere di interruzione 120 KA	Breaking capacity 120 KA	Pouvoir de coupure 120 KA
Norme riferimento DIN VDE0636-201(1998-06) IEC 60269-1:2005 EN 60269-1:1998+A1:2005 IEC 60269-2:1986+Corr.1:1996 +A11995+A2:2001 EN 60269-2:1995+A1:1998+A2:2002 IEC 60269-2-1:2004 HD 60269-2-1:2005 DIN43620 Parts 1 of 4	Standards DIN VDE0636-201(1998-06) IEC 60269-1:2005 EN 60269-1:1998+A1:2005 IEC 60269-2:1986+Corr.1:1996 +A11995+A2:2001 EN 60269-2:1995+A1:1998+A2:2002 IEC 60269-2-1:2004 HD 60269-2-1:2005 DIN43620 Parts 1 of 4	Normes DIN VDE0636-201(1998-06) IEC 60269-1:2005 EN 60269-1:1998+A1:2005 IEC 60269-2:1986+Corr.1:1996 +A11995+A2:2001 EN 60269-2:1995+A1:1998+A2:2002 IEC 60269-2-1:2004 HD 60269-2-1:2005 DIN43620 Parts 1 of 4
Classe di isolamento C - VDE 0110	Insulating class C - VDE 0110	Classe d'isolation C - VDE 0110

pag. 54-57



Corrente nominale Rated current Courant nominal	Codice Code Code	Pot. dissipata Power loss Puiss. dissipée	I ² t I ² t I ² t	Peso g. Weight Poids g.	
25 A	NH1G025	2,8	2600	233	3/45
32 A	NH1G032	-	3780	233	3/45
35 A	NH1G035	3,8	6300	233	3/45
40 A	NH1G040	4,2	6700	233	3/45
50 A	NH1G050	5,8	10500	233	3/45
63 A	NH1G063	6,1	21000	233	3/45
80 A	NH1G080	6,9	35000	233	3/45
100 A	NH1G100	8,8	46800	233	3/45
125 A	NH1G125	10,9	70000	233	3/45
160 A	NH1G160	13,3	122000	233	3/45
200 A	NH1G200	15,2	244000	430	3/24
224 A	NH1G224	18,0	305000	430	3/24
250 A	NH1G250	21,8	383000	430	3/24

pronta
in stock
en stock

25÷160 A versione NH1C - 200÷250 A versione NH1
25÷160 A version NH1C - 200÷250 A version NH1
25÷160 A version NH1C - 200÷250 A version NH1



FUSIBILI NH2 gL-gG KOMBİ CON DOPPIO INDICATORE
Kombi NH2 gL-gG fuses with double indicator | Fusibles NH2 gL-gG kombi avec double indicateur

Tensione 500 V	Voltage 500 V	Tension 500 V
Potere di interruzione 120 KA	Breaking capacity 120 KA	Pouvoir de coupure 120 KA
Norme riferimento DIN VDE0636-201(1998-06) IEC 60269-1:2005 EN 60269-1:1998+A1:2005 IEC 60269-2:1986+Corr.1:1996 +A11995+A2:2001 EN 60269-2:1995+A1:1998+A2:2002 IEC 60269-2-1:2004 HD 60269-2-1:2005 DIN43620 Parts 1 of 4	Standards DIN VDE0636-201(1998-06) IEC 60269-1:2005 EN 60269-1:1998+A1:2005 IEC 60269-2:1986+Corr.1:1996 +A11995+A2:2001 EN 60269-2:1995+A1:1998+A2:2002 IEC 60269-2-1:2004 HD 60269-2-1:2005 DIN43620 Parts 1 of 4	Normes DIN VDE0636-201(1998-06) IEC 60269-1:2005 EN 60269-1:1998+A1:2005 IEC 60269-2:1986+Corr.1:1996 +A11995+A2:2001 EN 60269-2:1995+A1:1998+A2:2002 IEC 60269-2-1:2004 HD 60269-2-1:2005 DIN43620 Parts 1 of 4
Classe di isolamento C - VDE 0110	Insulating class C - VDE 0110	Classe d'isolation C - VDE 0110

pag. 52-57



Corrente nominale Rated current Courant nominal	Codice Code Code	Pot. dissipata Power loss Puiss. dissipée	I ² t I ² t I ² t	Peso g. Weight Poids g.
63 A	NH2G063	7,2	21000	430
80 A	NH2G080	7,9	35000	430
100 A	NH2G100	8,5	46800	430
125 A	NH2G125	10,7	70000	430
160 A	NH2G160	13,3	122000	430
200 A	NH2G200	16,6	244000	430
224 A	NH2G224	18,5	305000	430
250 A	NH2G250	21,8	383000	430
280 A	NH2G280	19,8	-	500
300 A	NH2G300	22,2	-	500
315 A	NH2G315	24,1	685000	500
355 A	NH2G355	28,1	970000	500
400 A	NH2G400	30,7	1100000	500

63÷250 A versione NH2C - 280÷400 A versione NH2
63÷250 A version NH2C - 280÷400 A version NH2
63÷250 A version NH2C - 280÷400 A version NH2

3/15 pz
3/15 pcs
3/15 pces

pronta
in stock
en stock

SERIE NH

NH series | Série NH



FUSIBILI NH3 gL-gG KOMBI CON DOPPIO INDICATORE

Kombi NH3 gL-gG fuses with double indicator | Fusibles NH3 gL-gG kombi avec double indicateur

Tensione 500 V	Voltage 500 V	Tension 500 V
Potere di interruzione 120 KA	Breaking capacity 120 KA	Pouvoir de coupure 120 KA
Norme riferimento DIN VDE0636-201(1998-06) IEC 60269-1:2005 EN 60269-1:1998+A1:2005 IEC 60269-2:1986+Corr.1:1996 +A11995+A2:2001 EN 60269-2:1995+A1:1998+A2:2002 IEC 60269-2-1:2004 HD 60269-2-1:2005 DIN43620 Parts 1 of 4	Standards DIN VDE0636-201(1998-06) IEC 60269-1:2005 EN 60269-1:1998+A1:2005 IEC 60269-2:1986+Corr.1:1996 +A11995+A2:2001 EN 60269-2:1995+A1:1998+A2:2002 IEC 60269-2-1:2004 HD 60269-2-1:2005 DIN43620 Parts 1 of 4	Normes DIN VDE0636-201(1998-06) IEC 60269-1:2005 EN 60269-1:1998+A1:2005 IEC 60269-2:1986+Corr.1:1996 +A11995+A2:2001 EN 60269-2:1995+A1:1998+A2:2002 IEC 60269-2-1:2004 HD 60269-2-1:2005 DIN43620 Parts 1 of 4
Classe di isolamento C - VDE 0110	Insulating class C - VDE 0110	Classe d'isolation C - VDE 0110

pag. 54-57



Corrente nominale Rated current Courant nominal	Codice Code Code	Pot. dissipata Power loss Puiss. dissipée	I ² t I ² t I ² t	Peso g. Weight Poids g.
250 A	NH3G250	21,8	383000	510
280 A	NH3G280	-	-	510
300 A	NH3G300	-	-	510
315 A	NH3G315	22,7	685000	510
355 A	NH3G355	-	970000	510
400 A	NH3G400	34,0	1100000	510
425 A	NH3G425	-	-	923
500 A	NH3G500	39,0	2600000	923
560 A	NH3G560	-	-	923
630 A	NH3G630	45,0	4460000	923



250÷400 A versione NH3C - 425÷630 A versione NH3
250÷400 A version NH3C - 425÷630 A version NH3
250÷400 A version NH3C - 425÷630 A version NH3



3/12 pz
3/12 pcs
3/12 pces



pronta
in stock
en stock



FUSIBILI NH4 e NH4a gL - gG

NH4 and NH4a gL-gG fuses | Fusibles NH4 et NH4a gL-gG

Tensione 500 V	Voltage 500 V	Tension 500 V
Potere di interruzione 120 KA	Breaking capacity 120 KA	Pouvoir de coupure 120 KA
Norme riferimento DIN VDE0636-201(1998-06) IEC 60269-1:2005 EN 60269-1:1998+A1:2005 IEC 60269-2:1986+Corr.1:1996 +A11995+A2:2001 EN 60269-2:1995+A1:1998+A2:2002 IEC 60269-2-1:2004 HD 60269-2-1:2005 DIN43620 Parts 1 of 4	Standards DIN VDE0636-201(1998-06) IEC 60269-1:2005 EN 60269-1:1998+A1:2005 IEC 60269-2:1986+Corr.1:1996 +A11995+A2:2001 EN 60269-2:1995+A1:1998+A2:2002 IEC 60269-2-1:2004 HD 60269-2-1:2005 DIN43620 Parts 1 of 4	Normes DIN VDE0636-201(1998-06) IEC 60269-1:2005 EN 60269-1:1998+A1:2005 IEC 60269-2:1986+Corr.1:1996 +A11995+A2:2001 EN 60269-2:1995+A1:1998+A2:2002 IEC 60269-2-1:2004 HD 60269-2-1:2005 DIN43620 Parts 1 of 4
Classe di isolamento C - VDE 0110	Insulating class C - VDE 0110	Classe d'isolation C - VDE 0110

pag. 54-57



Corrente nominale Rated current Courant nominal	Codice Code Code	Pot. dissipata Power loss Puiss. dissipée	I ² t I ² t I ² t	Peso g. Weight Poids g.
NH4				
630 A	NH4G630	43,0	4460000	2130
710 A	NH4G710	-	-	2130
800 A	NH4G800	59,0	6100000	2130
900 A	NH4G900	-	-	2130
1000 A	NH4G1000	84,0	11100000	2130
1250 A	NH4G1250	104	20000000	2130
NH4a				
630 A	NH4aG630	-	-	2170
800 A	NH4aG800	-	-	2170
1000 A	NH4aG1000	-	-	2170
1250 A	NH4aG1250	-	-	2170
1600 A	NH4aG1600	-	-	2170



1/12 pz
1/12 pcs
1/12 pces



pronta
in stock
en stock

SERIE NH
NH series | Série NH



FUSIBILI NH00 gL-gG KOMBI CON DOPPIO INDICATORE
Kombi NH00 gL-gG fuses with double indicator | Fusibles NH00 gL-gG kombi avec double indicateur

Tensione
690 V

Potere di interruzione
100 KA

Norme riferimento

DIN VDE0636-201(1998-06)
IEC 60269-1:2005
EN 60269-1:1998+A1:2005
IEC 60269-2:1986+Corr.1:1996
+A11995+A2:2001
EN 60269-2:1995+A1:1998+A2:2002
IEC 60269-2-1:2004
HD 60269-2-1:2005
DIN43620 Parts 1 of 4

Classe di isolamento
C - VDE 0110

Voltage
690 V

Breaking capacity
100 KA

Standards

DIN VDE0636-201(1998-06)
IEC 60269-1:2005
EN 60269-1:1998+A1:2005
IEC 60269-2:1986+Corr.1:1996
+A11995+A2:2001
EN 60269-2:1995+A1:1998+A2:2002
IEC 60269-2-1:2004
HD 60269-2-1:2005
DIN43620 Parts 1 of 4

Insulating class
C - VDE 0110

Tension
690 V

Pouvoir de coupure
100 KA

Normes

DIN VDE0636-201(1998-06)
IEC 60269-1:2005
EN 60269-1:1998+A1:2005
IEC 60269-2:1986+Corr.1:1996
+A11995+A2:2001
EN 60269-2:1995+A1:1998+A2:2002
IEC 60269-2-1:2004
HD 60269-2-1:2005
DIN43620 Parts 1 of 4

Classe d'isolation
C - VDE 0110

pag. 54-57



Corrente nominale Rated current Courant nominal	Codice Code Code	Pot. dissipata Power loss Puiss. dissipée	l'ft l'ft l'ft	Peso g. Weight Poids g.	
2 A	NHS00G002	1,0	-	125	3/120
4 A	NHS00G004	1,3	-	125	3/120
6 A	NHS00G006	1,5	200	125	3/120
10 A	NHS00G010	1,6	600	125	3/120
16 A	NHS00G016	2,0	1500	125	3/120
20 A	NHS00G020	2,2	3800	125	3/120
25 A	NHS00G025	2,8	6800	125	3/120
32 A	NHS00G032	-	8300	125	3/120
35 A	NHS00G035	3,8	10000	125	3/120
40 A	NHS00G040	4,1	16000	125	3/120
50 A	NHS00G050	5,6	22000	125	3/120
63 A	NHS00G063	5,9	30000	173	3/90
80 A	NHS00G080	6,6	50000	173	3/90
100 A	NHS00G100	7,3	80000	173	3/90
125 A	NHS00G125	10,2	140000	173	3/90

Isolati | Isulated | Isolés

2 A	NHSI00G002	1,0	-	125	3/120
4 A	NHSI00G004	1,3	-	125	3/120
6 A	NHSI00G006	1,5	200	125	3/120
10 A	NHSI00G010	1,6	600	125	3/120
16 A	NHSI00G016	2,0	1500	125	3/120
20 A	NHSI00G020	2,2	3800	125	3/120
25 A	NHSI00G025	2,8	6800	125	3/120
32 A	NHSI00G032	-	8300	125	3/120
35 A	NHSI00G035	3,8	10000	125	3/120
40 A	NHSI00G040	4,1	16000	125	3/120
50 A	NHSI00G050	5,6	22000	125	3/120
63 A	NHSI00G063	5,9	30000	173	3/90
80 A	NHSI00G080	6,6	50000	173	3/90
100 A	NHSI00G100	7,3	80000	173	3/90
125 A	NHSI00G125	10,2	140000	173	3/90

30 giorni
30 days
30 jours

2=50 A versione NH00C - 63=125 A versione NH00
2=50 A version NH00C - 63=125 A version NH00
2=50 A version NH00C - 63=125 A version NH00



FUSIBILI NH0 gL-gG KOMBI CON DOPPIO INDICATORE
Kombi NH0 gL-gG fuses with double indicator | Fusibles NH0 gL-gG kombi avec double indicateur

Tensione
690 V

Potere di interruzione
100 KA

Norme riferimento

DIN VDE0636-201(1998-06)
IEC 60269-1:2005
EN 60269-1:1998+A1:2005
IEC 60269-2:1986+Corr.1:1996
+A11995+A2:2001
EN 60269-2:1995+A1:1998+A2:2002
IEC 60269-2-1:2004
HD 60269-2-1:2005
DIN43620 Parts 1 of 4

Classe di isolamento
C - VDE 0110

Voltage
690 V

Breaking capacity
100 KA

Standards

DIN VDE0636-201(1998-06)
IEC 60269-1:2005
EN 60269-1:1998+A1:2005
IEC 60269-2:1986+Corr.1:1996
+A11995+A2:2001
EN 60269-2:1995+A1:1998+A2:2002
IEC 60269-2-1:2004
HD 60269-2-1:2005
DIN43620 Parts 1 of 4

Insulating class
C - VDE 0110

Tension
690 V

Pouvoir de coupure
100 KA

Normes

DIN VDE0636-201(1998-06)
IEC 60269-1:2005
EN 60269-1:1998+A1:2005
IEC 60269-2:1986+Corr.1:1996
+A11995+A2:2001
EN 60269-2:1995+A1:1998+A2:2002
IEC 60269-2-1:2004
HD 60269-2-1:2005
DIN43620 Parts 1 of 4

Classe d'isolation
C - VDE 0110

pag. 54-57



Corrente nominale Rated current Courant nominal	Codice Code Code	Pot. dissipata Power loss Puiss. dissipée	l'ft l'ft l'ft	Peso g. Weight Poids g.
6 A	NHS0G006	1,8	200	226
10 A	NHS0G010	1,2	600	226
16 A	NHS0G016	2,1	1500	226
20 A	NHS0G020	2,2	3800	226
25 A	NHS0G025	2,9	6800	226
32 A	NHS0G032	-	8300	226
35 A	NHS0G035	3,8	10000	226
40 A	NHS0G040	4,2	16000	226
50 A	NHS0G050	5,7	22000	226
63 A	NHS0G063	6,8	30000	226
80 A	NHS0G080	6,8	50000	226
100 A	NHS0G100	7,5	80000	226
125 A	NHS0G125	10,9	140000	226

3/45 pz
3/45 pcs
3/45 pces

30 giorni
30 days
30 jours

SERIE NH

NH series | Série NH



FUSIBILI NH1 gL-gG KOMBI CON DOPPIO INDICATORE

Kombi NH1 gL-gG fuses with double indicator | Fusibles NH1 gL-gG kombi avec double indicateur

Tensione 690 V	Voltage 690 V	Tension 690 V
Potere di interruzione 100 KA	Breaking capacity 120 KA	Pouvoir de coupure 120 KA
Norme riferimento DIN VDE0636-201(1998-06) IEC 60269-1:2005 EN 60269-1:1998+A1:2005 IEC 60269-2:1986+Corr.1:1996 +A11995+A2:2001 EN 60269-2:1995+A1:1998+A2:2002 IEC 60269-2-1:2004 HD 60269-2-1:2005 DIN43620 Parts 1 of 4	Standards DIN VDE0636-201(1998-06) IEC 60269-1:2005 EN 60269-1:1998+A1:2005 IEC 60269-2:1986+Corr.1:1996 +A11995+A2:2001 EN 60269-2:1995+A1:1998+A2:2002 IEC 60269-2-1:2004 HD 60269-2-1:2005 DIN43620 Parts 1 of 4	Normes DIN VDE0636-201(1998-06) IEC 60269-1:2005 EN 60269-1:1998+A1:2005 IEC 60269-2:1986+Corr.1:1996 +A11995+A2:2001 EN 60269-2:1995+A1:1998+A2:2002 IEC 60269-2-1:2004 HD 60269-2-1:2005 DIN43620 Parts 1 of 4
Classe di isolamento C - VDE 0110	Insulating class C - VDE 0110	Classe d'isolation C - VDE 0110

pag. 54-57



Corrente nominale Rated current Courant nominal	Codice Code Code	Pot. dissipata Power loss Puiss. dissipée	I ² t I ² t I ² t	Peso g. Weight Poids g.	
25 A	NHS1G025	3,0	6800	233	3/45
32 A	NHS1G032	-	8300	233	3/45
35 A	NHS1G035	3,9	10000	233	3/45
40 A	NHS1G040	4,3	16000	233	3/45
50 A	NHS1G050	5,9	22000	233	3/45
63 A	NHS1G063	6,2	30000	233	3/45
80 A	NHS1G080	7,1	50000	233	3/45
100 A	NHS1G100	9,0	80000	233	3/45
125 A	NHS1G125	11,5	140000	233	3/45
160 A	NHS1G160	16,2	200000	430	3/24
200 A	NHS1G200	17,0	400000	430	3/24
224 A	NHS1G224	19,0	-	430	3/24
250 A	NHS1G250	-	-	430	3/24

30 giorni
30 days
30 jours

25÷125 A versione NH1C - 160÷250 A versione NH1
25÷125 A version NH1C - 160÷250 A version NH1
25÷125 A version NH1C - 160÷250 A version NH1



FUSIBILI NH1 gL-gG

NH1 gL-gG fuses | Fusibles NH1 gL-gG

Tensione 1000 V	Voltage 1000 V	Tension 1000 V
Potere di interruzione 50 KA	Breaking capacity 50 KA	Pouvoir de coupure 50 KA
Norme riferimento DIN VDE0636-201(1998-06) IEC 60269-1:2005 EN 60269-1:1998+A1:2005 IEC 60269-2:1986+Corr.1:1996 +A11995+A2:2001 EN 60269-2:1995+A1:1998+A2:2002 IEC 60269-2-1:2004 HD 60269-2-1:2005 DIN43620 Parts 1 of 4	Standards DIN VDE0636-201(1998-06) IEC 60269-1:2005 EN 60269-1:1998+A1:2005 IEC 60269-2:1986+Corr.1:1996 +A11995+A2:2001 EN 60269-2:1995+A1:1998+A2:2002 IEC 60269-2-1:2004 HD 60269-2-1:2005 DIN43620 Parts 1 of 4	Normes DIN VDE0636-201(1998-06) IEC 60269-1:2005 EN 60269-1:1998+A1:2005 IEC 60269-2:1986+Corr.1:1996 +A11995+A2:2001 EN 60269-2:1995+A1:1998+A2:2002 IEC 60269-2-1:2004 HD 60269-2-1:2005 DIN43620 Parts 1 of 4
Classe di isolamento C - VDE 0110	Insulating class C - VDE 0110	Classe d'isolation C - VDE 0110

pag. 54-57



Corrente nominale Rated current Courant nominal	Codice Code Code	Peso g. Weight Poids g.
10 A	NHM1G010	487
16 A	NHM1G016	487
20 A	NHM1G020	487
25 A	NHM1G025	487
32 A	NHM1G032	487
35 A	NHM1G035	487
40 A	NHM1G040	487
50 A	NHM1G050	487
63 A	NHM1G063	487
80 A	NHM1G080	487
100 A	NHM1G100	487
125 A	NHM1G125	487
160 A	NHM1G160	487
200 A	NHM1G200	487

3/24 pz
3/24 pcs
3/24 pces

30 giorni
30 days
30 jours

SERIE NH
NH series | Série NH



FUSIBILI NH2 KOMBI gL-gG CON DOPPIO INDICATORE
Kombi NH2 gL-gG fuses with double indicator | Fusibles NH2 gL-gG kombi avec double indicateur

Tensione 690 V	Voltage 690 V	Tension 690 V
Potere di interruzione 100 KA	Breaking capacity 100 KA	Pouvoir de coupure 100 KA
Norme riferimento DIN VDE0636-201(1998-06) IEC 60269-1:2005 EN 60269-1:1998+A1:2005 IEC 60269-2:1986+Corr.1:1996 +A11995+A2:2001 EN 60269-2:1995+A1:1998+A2:2002 IEC 60269-2-1:2004 HD 60269-2-1:2005 DIN43620 Parts 1 of 4	Standards DIN VDE0636-201(1998-06) IEC 60269-1:2005 EN 60269-1:1998+A1:2005 IEC 60269-2:1986+Corr.1:1996 +A11995+A2:2001 EN 60269-2:1995+A1:1998+A2:2002 IEC 60269-2-1:2004 HD 60269-2-1:2005 DIN43620 Parts 1 of 4	Normes DIN VDE0636-201(1998-06) IEC 60269-1:2005 EN 60269-1:1998+A1:2005 IEC 60269-2:1986+Corr.1:1996 +A11995+A2:2001 EN 60269-2:1995+A1:1998+A2:2002 IEC 60269-2-1:2004 HD 60269-2-1:2005 DIN43620 Parts 1 of 4
Classe di isolamento C - VDE 0110	Insulating class C - VDE 0110	Classe d'isolation C - VDE 0110

pag. 54-57



Corrente nominale Rated current Courant nominal	Codice Code Code	Pot. dissipata Power loss Puiss. dissipée	I ² t I ² t I ² t	Peso g. Weight Poids g.
63 A	NHS2G063	7,3	30000	430
80 A	NHS2G080	8,0	50000	430
100 A	NHS2G100	9,5	80000	430
125 A	NHS2G125	11,8	140000	430
160 A	NHS2G160	13,5	200000	430
200 A	NHS2G200	17,2	400000	430
224 A	NHS2G224	18,0	600000	430
250 A	NHS2G250	22,7	800000	430
280 A	NHS2G280	-	-	500
300 A	NHS2G300	-	-	500
315 A	NHS2G315	26,8	1500000	500

63÷250 A versione NH2C - 280÷315 A versione NH2
63÷250 A version NH2C - 280÷315 A version NH2
63÷250 A version NH2C - 280÷315 A version NH2

3/15 pz
3/15 pcs
3/15 pces

30 giorni
30 days
30 jours



FUSIBILI NH3 gL-gG KOMBI CON DOPPIO INDICATORE
Kombi NH3 gL-gG fuses with double indicator | Fusibles NH3 gL-gG kombi avec double indicateur

Tensione 690 V	Voltage 690 V	Tension 690 V
Potere di interruzione 100 KA	Breaking capacity 100 KA	Pouvoir de coupure 100 KA
Norme riferimento DIN VDE0636-201(1998-06) IEC 60269-1:2005 EN 60269-1:1998+A1:2005 IEC 60269-2:1986+Corr.1:1996 +A11995+A2:2001 EN 60269-2:1995+A1:1998+A2:2002 IEC 60269-2-1:2004 HD 60269-2-1:2005 DIN43620 Parts 1 of 4	Standards DIN VDE0636-201(1998-06) IEC 60269-1:2005 EN 60269-1:1998+A1:2005 IEC 60269-2:1986+Corr.1:1996 +A11995+A2:2001 EN 60269-2:1995+A1:1998+A2:2002 IEC 60269-2-1:2004 HD 60269-2-1:2005 DIN43620 Parts 1 of 4	Normes DIN VDE0636-201(1998-06) IEC 60269-1:2005 EN 60269-1:1998+A1:2005 IEC 60269-2:1986+Corr.1:1996 +A11995+A2:2001 EN 60269-2:1995+A1:1998+A2:2002 IEC 60269-2-1:2004 HD 60269-2-1:2005 DIN43620 Parts 1 of 4
Classe di isolamento C - VDE 0110	Insulating class C - VDE 0110	Classe d'isolation C - VDE 0110

pag. 54-57



Corrente nominale Rated current Courant nominal	Codice Code Code	Pot. dissipata Power loss Puiss. dissipée	I ² t I ² t I ² t	Peso g. Weight Poids g.
250 A	NHS3G250	22,7	800000	510
280 A	NHS3G280	-	-	510
315 A	NHS3G315	26,8	1500000	510
355 A	NHS3G355	-	1600000	923
400 A	NHS3G400	40	2000000	923
425 A	NHS3G425	-	-	923
500 A	NHS3G500	3	4000000	923
•630 A	NHS3G630	-	-	923

• in fase di eliminazione
to be discontinued
en phase d'élimination

250÷315 A versione NH3C - 355÷500 A versione NH3
250÷315 A version NH3C - 355÷500 A version NH3
250÷315 A version NH3C - 355÷500 A version NH3

3/12 pz
3/12 pcs
3/12 pces

30 giorni
30 days
30 jours

SERIE NH

NH series | Série NH



FUSIBILI NH00 aM KOMBI CON DOPPIO INDICATORE NH00 aM fuses with double indicator | Fusibles NH00 aM kombi avec double indicateur

Tensione 500 V/690 V	Voltage 500 V/690 V	Tension 500 V/690 V
Potere di interruzione 100 KA	Breaking capacity 100 KA	Pouvoir de coupure 100 KA
Norme riferimento DIN 43620, IEC 60269, EN60269 aM acc. to VDE 0636-2011, DIN VDE 0636	Standards DIN 43620, IEC 60269, EN60269 aM acc. to VDE 0636-2011, DIN VDE 0636	Normes DIN 43620, IEC 60269, EN60269 aM acc. to VDE 0636-2011, DIN VDE 0636
Classe di isolamento C - VDE 0110	Insulating class C - VDE 0110	Classe d'isolation C - VDE 0110

pag. 54-57



Corrente nominale Rated current Courant nominale	Codice Code Code	Tensione Voltage Tension	Peso g. Weight Poids g.	
16 A	NH00M016	690 V	135	3/120
20 A	NH00M020	690 V	135	3/120
25 A	NH00M025	690 V	135	3/120
32 A	NH00M032	690 V	135	3/120
35 A	NH00M035	690 V	135	3/120
40 A	NH00M040	690 V	135	3/120
50 A	NH00M050	690 V	135	3/120
63 A	NH00M063	690 V	135	3/120
80 A	NH00M080	500 V	135	3/120
100 A	NH00M100	500 V	135	3/120
• 125 A	NH00M125	690 V	198	3/60
• 160 A	NH00M160	690 V	198	3/60

2÷100 A versione NH00C - 125÷160 A versione NH00
2÷100 A version NH00C - 125÷160 A version NH00
2÷100 A version NH00C - 125÷160 A version NH00

pronta
in stock
en stock

• 125÷160 A senza indicatore centrale
125÷160 A without central indicator
125÷160 A sans indicateur central



FUSIBILI NH0 aM NH0 aM fuses | Fusibles NH0 aM

Tensione 690 V	Voltage 690 V	Tension 690 V
Potere di interruzione 100 KA	Breaking capacity 100 KA	Pouvoir de coupure 100 KA
Norme riferimento DIN 43620, IEC 60269, EN60269 aM acc. to VDE 0636-2011, DIN VDE 0636	Standards DIN 43620, IEC 60269, EN60269 aM acc. to VDE 0636-2011, DIN VDE 0636	Normes DIN 43620, IEC 60269, EN60269 aM acc. to VDE 0636-2011, DIN VDE 0636
Classe di isolamento C - VDE 0110	Insulating class C - VDE 0110	Classe d'isolation C - VDE 0110

pag. 54-57



Corrente nominale Rated current Courant nominale	Codice Code Code	Peso g. Weight Poids g.
16 A	NH0M016	226
20 A	NH0M020	226
25 A	NH0M025	226
32 A	NH0M032	226
35 A	NH0M035	226
40 A	NH0M040	226
50 A	NH0M050	226
63 A	NH0M063	226
80 A	NH0M080	226
100 A	NH0M100	226
125 A	NH0M125	226
160 A	NH0M160	226

3/45 pz
3/45 pcs
3/45 pces

Senza indicatore centrale
Without central indicator
Sans indicateur central

SERIE NH
NH series | Série NH



FUSIBILI NH1 aM KOMBI CON DOPPIO INDICATORE

Kombi NH1 aM fuses with double indicator | Fusibles NH1 aM kombi avec double indicateur

Tensione 690 V	Voltage 690 V	Tension 690 V
Potere di interruzione 100 KA	Breaking capacity 100 KA	Pouvoir de coupure 100 KA
Norme riferimento DIN 43620, IEC 60269, EN60269 aM acc. to VDE 0636-2011, DIN VDE 0636	Standards DIN 43620, IEC 60269, EN60269 aM acc. to VDE 0636-2011, DIN VDE 0636	Normes DIN 43620, IEC 60269, EN60269 aM acc. to VDE 0636-2011, DIN VDE 0636
Classe di isolamento C - VDE 0110	Insulating class C - VDE 0110	Classe d'isolation C - VDE 0110

pag. 54-57



Corrente nominale Rated current Courant nominale	Codice Code Code	Peso g. Weight Poids g.	
50 A	NH1M050	430	3/24
63 A	NH1M063	430	3/24
80 A	NH1M080	430	3/24
100 A	NH1M100	430	3/24
125 A	NH1M125	430	3/24
160 A	NH1M160	430	3/24
200 A	NH1M200	430	3/24
224 A	NH1M224	430	3/24
250 A	NH1M250	430	3/24

pronta
in stock
en stock



FUSIBILI NH2 aM - NH3 aM - NH4 aM KOMBI CON DOPPIO INDICATORE

Kombi NH2 aM - NH3 aM - NH4 aM fuses with double indicator | Fusibles NH2 aM - NH3 aM - NH4 aM kombi avec double indicateur

Tensione 690 V	Voltage 690 V	Tension 690 V
Potere di interruzione 100 KA	Breaking capacity 100 KA	Pouvoir de coupure 100 KA
Norme riferimento DIN 43620, IEC 60269, EN60269 aM acc. to VDE 0636-2011, DIN VDE 0636	Standards DIN 43620, IEC 60269, EN60269 aM acc. to VDE 0636-2011, DIN VDE 0636	Normes DIN 43620, IEC 60269, EN60269 aM acc. to VDE 0636-2011, DIN VDE 0636
Classe di isolamento C - VDE 0110	Insulating class C - VDE 0110	Classe d'isolation C - VDE 0110

pag. 54-57



Corrente nominale Rated current Courant nominal	Codice Code Code	Peso g. Weight Poids g.	
NH2			
63 A	NH2M063	430	3/15
80 A	NH2M080	430	3/15
100 A	NH2M100	430	3/15
125 A	NH2M125	430	3/15
160 A	NH2M160	430	3/15
200 A	NH2M200	430	3/15
224 A	NH2M224	430	3/15
250 A	NH2M250	430	3/15
280 A	NH2M280	500	3/15
300 A	NH2M300	500	3/15
315 A	NH2M315	500	3/15
355 A	NH2M355	500	3/15
400 A	NH2M400	500	3/15
NH3			
355 A	NH3M355	923	3/12
400 A	NH3M400	923	3/12
425 A	NH3M425	923	3/12
500 A	NH3M500	923	3/12
•560 A	NH3M560	923	3/12
•630 A	NH3M630	923	3/12
NH4a			
•630A	NH4aM630		1/12 NEW
•710A	NH4aM710		1/12 NEW
•800A	NH4aM800		1/12 NEW
•900A	NH4aM900		1/12 NEW
•1000A	NH4aM1000		1/12 NEW
•1250A	NH4aM1250		1/12 NEW

in fase di eliminazione
to be discontinued
en phase d'élimination

•560÷630 A senza indicatore centrale
560÷630 A without central indicator
560÷630 A sans indicateur central

63÷250 A versione NH2C - 280÷400 A versione NH2
63÷250 A version NH2C - 280÷400 A version NH2
63÷250 A version NH2C - 280÷400 A version NH2

pronta
in stock
en stock

SERIE NH
NH series | Série NH

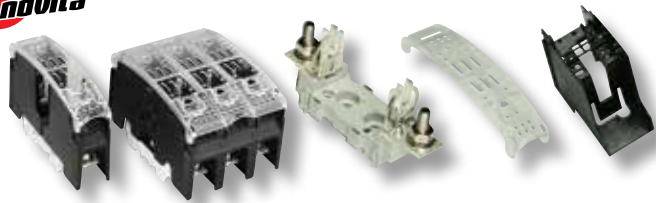

BASE MODULARE NH00 TERMOPLASTICA

NH00 thermoplastic modular bases | Base modulaire NH00 thermoplastiques

Tensione 690V	Voltage 690V	Tension 690V
Corrente 160A	Current 160A	Courant 160A
Fissaggio Bullone e guida DIN	Mounting DIN rail and bolt	Fixation Boulon et Rail DIN
Classe di isolamento C-VDE 0110	Insulating class C-VDE 0110	Classe d'isolation C-VDE 0110
Norme riferimento IEC EN60269 DIN 43620 DIN 43623	Standards IEC EN60269 DIN 43620 DIN 43623	Normes IEC EN60269 DIN 43620 DIN 43623

pag. 58-59



Codice Code Code	Contatti Contacts Contacts	N°poli N°poles N°pôles	Fissaggio Mounting Fixation	
NH00B0104	M8+M8	1	bullone/bolt/boulon	3
NH00B0304	M8+M8	3	bullone/bolt/boulon	1
•NH00B0104/DIN	M8+M8	1	guida DIN/rail DIN/DIN rail	3
•NH00B0304/DIN	M8+M8	3	guida DIN/rail DIN/DIN rail	1

ACCESSORI IP20

IP20 Accessories | Accessoires IP20

Grandezza Size Taille	Descrizione Description Description	
NH9P0000	Protezione unipolare/Single-pole protection/Protections unipolaire	1
NH9P0300	Protezione tripolare/Three-pole protection/Protections tripolaire	1
NH9C0000	Coperchio unipolare/Single-pole cover/Couvercles unipolaire	1
NH9C0300	Coperchio tripolare/Three-pole cover/Couvercles tripolaire	1
NH9S0000	Separatore unipolare/ Single-pole partition walls/Séparateurs unipolaire	1
NH9S0300	Separatore tripolare/Three-pole partition walls/Séparateurs tripolaire	1

pronta
in stock
en stock

• completa di attacco guida DIN
ready for rail DIN
Kit de fixations pour Rail DIN

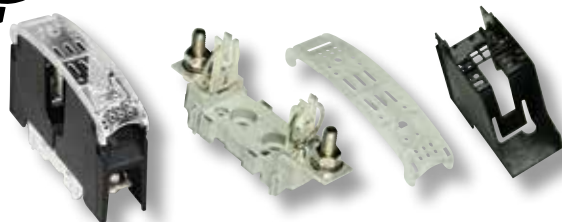

BASE MODULARE NH1 TERMOPLASTICA

NH1 thermoplastic modular bases | Base modulaire NH1 thermoplastiques

Tensione 690V	Voltage 690V	Tension 690V
Corrente 250A	Current 250A	Courant 250A
Fissaggio Bullone e guida DIN	Mounting DIN rail and bolt	Fixation Boulon et Rail DIN
Classe di isolamento C-VDE 0110	Insulating class C-VDE 0110	Classe d'isolation C-VDE 0110
Norme riferimento IEC EN60269 DIN 43620 DIN 43623	Standards IEC EN60269 DIN 43620 DIN 43623	Normes IEC EN60269 DIN 43620 DIN 43623

pag. 58-59



Codice Code Code	Contatti Contacts Contacts	N°poli N°poles N°pôles	Fissaggio Mounting Fixation	
NH1B0104	M10+M10	1	bullone/bolt/boulon	3
•NH1B0104/DIN	M10+M10	1	guida DIN/rail DIN/DIN rail	3

ACCESSORI IP20

IP20 Accessories | Accessoires IP20

Grandezza Size Taille	Descrizione Description Description	
NH9P0001	Protezione/Protection/Protection	1
NH9C0001	Coperchio/Cover/Couvercle	1
NH9S0001	Separatore/Partition walls/Séparateur	1
NH9A0000	Kit unione/Assembling kit/Kit d'union	1

pronta
in stock
en stock

• a richiesta versione con microintegrato
version with integrated micro upon request
sur demande version avec micro intégré

• completa di attacco guida DIN
ready for rail DIN
Kit de fixations pour Rail DIN

SERIE NH
NH series | Série NH



BASE MODULARE NH2 TERMOPLASTICA

NH2 thermoplastic modular bases | Base modulaire NH2 thermoplastiques

Tensione 690V	Voltage 690V	Tension 690V
Corrente 400A	Current 400A	Courant 400A
Fissaggio Bullone e guida DIN	Mounting DIN rail and bolt	Fixation Boulon et Rail DIN
Classe di isolamento C-VDE 0110	Insulating class C-VDE 0110	Classe d'isolation C-VDE 0110
Norme riferimento IEC EN60269 DIN 43620 DIN 43623	Standards IEC EN60269 DIN 43620 DIN 43623	Normes IEC EN60269 DIN 43620 DIN 43623

pag. 58-59



Codice Code Code	Contatti Contacts Contacts	N° poli N° poles N° pôles	Fissaggio Mounting Fixation	
NH2B0104	M12+M12	1	bullone/bolt/boulon	1
•NH2B0104/DIN	M12+M12	1	guida DIN/rail DIN/DIN rail	1

ACCESSORI IP20

IP20 Accessories | Accessoires IP20

Grandezza Size Taille	Descrizione Description Description	
NH9P0002	Protezione/Protection/Protection	1
NH9C0002	Coperchio/Cover/Couvercle	1
NH9S0002	Separatore/Partition walls/Séparateur	1
NH9A0000	Kit unione/Assembling kit/Kit d'union	1



• a richiesta versione con microintegrato
version with integrated micro upon request
sur demande version avec micro intégré



• completa di attacco guida DIN
ready for rail DIN
Kit de fixations pour Rail DIN

pronta
in stock
en stock



BASE MODULARE NH3 TERMOPLASTICA

NH3 thermoplastic modular bases | Base modulaire NH3 thermoplastiques

Tensione 690V	Voltage 690V	Tension 690V
Corrente 400A	Current 400A	Courant 400A
Fissaggio Bullone e guida DIN	Mounting DIN rail and bolt	Fixation Boulon et Rail DIN
Classe di isolamento C-VDE 0110	Insulating class C-VDE 0110	Classe d'isolation C-VDE 0110
Norme riferimento IEC EN60269 DIN 43620 DIN 43623	Standards IEC EN60269 DIN 43620 DIN 43623	Normes IEC EN60269 DIN 43620 DIN 43623

pag. 58-59



Codice Code Code	Contatti Contacts Contacts	N° poli N° poles N° pôles	Fissaggio Mounting Fixation	
NH3B0104	M12+M12	1	bullone/bolt/boulon	1
•NH3B0104/DIN	M12+M12	1	guida DIN/rail DIN/DIN rail	1

ACCESSORI IP20

IP20 Accessories | Accessoires IP20

Grandezza Size Taille	Descrizione Description Description	
NH9P0003	Protezione/Protection/Protection	1
NH9C0003	Coperchio/Cover/Couvercle	1
NH9S0003	Separatore/Partition walls/Séparateur	1
NH9A0003	Kit unione/Assembling kit/Kit d'union	1



• a richiesta versione con microintegrato
version with integrated micro upon request
sur demande version avec micro intégré



• completa di attacco guida DIN
ready for rail DIN
Kit de fixations pour Rail DIN

pronta
in stock
en stock

SERIE NH

NH series | Série NH



BASE NH - METALLICA

NH metal base | Base NH - métallique

Tensione 690 V	Voltage 690 V	Tension 690 V
Per fusibili grandezza NH00 / NH0 NH1 / NH2 NH3 / NH4	For fuses (size) NH00 / NH0 NH1 / NH2 NH3 / NH4	Pour fusibles (taille) NH00 / NH0 NH1 / NH2 NH3 / NH4
Norme riferimento IEC 269 DIN VDE 636 DIN 43620 EN 60269 DIN 43623	Standards IEC 269 DIN VDE 636 DIN 43620 EN 60269 DIN 43623	Normes IEC 269 DIN VDE 636 DIN 43620 EN 60269 DIN 43623
Classe di isolamento C - VDE 0110	Insulating class C - VDE 0110	Classe d'isolation C - VDE 0110
Codice di omologazione ETI: PK	Approval code ETI: PK	Code d'homologation ETI: PK

pag. 56



Grandezza Size Taille	Codice Code Code	Contatti Contacts Contacts	A/V A/V A/V	Peso g. Weight Poids g.	
Unipolari Single-pole Unipolaires					
NH00	NH00B101	M8+M8	160 A/690 V	170	3/120
NH0	NH0B101	M8+M8	160 A/690 V	258	3/90
NH1	NH1B101	M10+M10	250 A/690 V	598	3/42
NH1	NH1B102	M10+M10	250 A/1000 V	665	3/30
NH2	NH2B101	M10+M10	400 A/690 V	995	3/30
NH3	NH3B101	M12+M12	630 A/690 V	1202	3/24
NH4	NH4B101	M12+M12	1250 A/500 V	3030	1/7
Tripolari Tree-pole Tripolaires					
• NH00	NH00B301	M8+M8	160 A/690 V	555	1/25
• NH0	NH0B301	M8+M8	160 A/690 V	650	1/18
• NH1	NH1B301	M10+M10	250 A/690 V	1900	1/10
• NH2	NH2B301	M10+M10	400 A/690 V	3035	1/6
• NH3	NH3B301	M12+M12	630 A/690 V	3800	1/6

Contatti | Contacts | Contacts

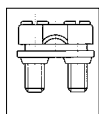

contatto a richiesta su tutte le basi:
2xM6 - cod. NH00B000
2xM6 contact available upon request on any bases:
NH00B000
contact sur demande sur toutes les bases:
2xM6 - NH00B000



• complete di separatori
partition wall included
inclus séparateurs

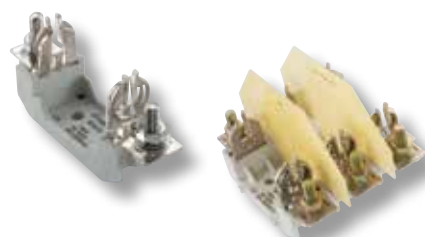

BASE NH - TERMOPLASTICA

NH thermoplastic base | Base NH - thermoplastique

Tensione 690 V	Voltage 690 V	Tension 690 V
Per fusibili grandezza NH00 / NH0 NH1 / NH2 NH3 / NH4	For fuses (size) NH00 / NH0 NH1 / NH2 NH3 / NH4	Pour fusibles (taille) NH00 / NH0 NH1 / NH2 NH3 / NH4
Norme riferimento IEC 269 DIN VDE 636 DIN 43620 EN 60269 DIN 43623	Standards IEC 269 DIN VDE 636 DIN 43620 EN 60269 DIN 43623	Normes IEC 269 DIN VDE 636 DIN 43620 EN 60269 DIN 43623
Classe di isolamento C - VDE 0110	Insulating class C - VDE 0110	Classe d'isolation C - VDE 0110

pag. 58



Grandezza Size Taille	Codice Code Code	Contatti Contacts Contacts	A/V A/V A/V	Peso Weight Poids
Unipolari Single-pole Unipolaires				
NH00	NH00B104	M8+M8	160 A/690 V	-
NH0	NH0B104	M8+M8	160 A/690 V	-
NH1	NH1B104	M10+M10	250 A/690 V	-
NH2	NH2B104	M12+M12	400 A/690 V	-
NH3	NH3B104	M12+M12	630 A/690 V	-
NH4	NH4B104	M16+M16	1250 A/690 V	-
Tripolari Tree-pole Tripolaires				
• NH00	NH00B304	M8+M8	160 A/690 V	-
• NH1	NH1B304	M10+M10	250 A/690 V	-
• NH2	NH2B304	M12+M12	400 A/690 V	-
• NH3	NH3B304	M12+M12	630 A/690 V	-

Contatti | Contacts | Contacts

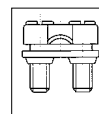

contatto a richiesta su tutte le basi:
2xM6 - cod. NH00B000
2xM6 contact available upon request on any bases:
NH00B000
contact sur demande sur toutes les bases:
2xM6 - NH00B000



unipolare 3 pz. - tripolari 1 pz
single-pole 3 pcs - three-pole 1 pc
unipolaires 3 pcs - tripolaire 1 pce



• complete di separatori
partition wall included
inclus séparateurs

SERIE NH

NH series | Série NH



BASI NH TERMOPLASTICHE COMPONENTI UNIPOLARI

Modular NH thermoplastic bases-Single pole | Bases NH thermoplastique modulaires-unipolaires

Tensione 690 V	Voltage 690 V	Tension 690 V
Per fusibili grandezza NH00÷NH3	For fuses (size) NH00÷NH3	Pour fusibles (taille) NH00÷NH3
Norme riferimento IEC - DIN EN - HRN EN 60269 DIN VDE 0636	Standards IEC - DIN EN - HRN EN 60269 DIN VDE 0636	Normes IEC - DIN EN - HRN EN 60269 DIN VDE 0636
Classe di isolamento C - VDE 0110	Insulating class C - VDE 0110	Classe d'isolation C - VDE 0110

pag. 59



Grandezza Size Taille	Codice Code Code	Contatti Contacts Contacts	A/V A/V A/V	Peso Weight Poids
NH00	NH00BN105	M8+M8	160 A/690 V	126
NH1	NH1BN105	M10+M10	250 A/690 V	340
NH2	NH2BN105	M10+M10	400 A/690 V	410
NH3	NH3BN105	M12+M12	630 A/690 V	637
Contatto neutro Earth clamp Contact neutre				
NH00	NH00TN101	M8+M8	160 A/690 V	128
NH1	NH1TN101	M10+M10	250 A/690 V	320
NH2	NH2TN101	M10+M10	400 A/690 V	387

Contatti | Contacts | Contacts

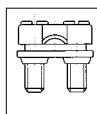

contatto a richiesta su tutte le basi:
2xM6 - cod. NH00B000
2xM6 contact available upon request on any bases:
NH00B000
contact sur demande sur toutes les bases:
2xM6 - NH00B000



3 pz
3 pcs
3 pces



pronta
in stock
en stock

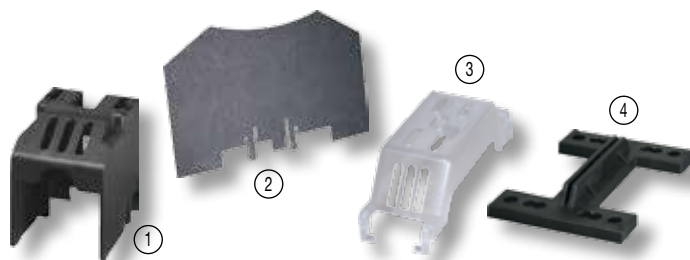

ACCESSORI

Accessories | Accessoires

Per fusibili grandezza NH00÷NH3	For fuses (size) NH00÷NH3	Pour fusibles (taille) NH00÷NH3
---	-------------------------------------	---

pag. 59



Grandezza Size Taille	Codice Code Code	Peso g. Weight Poids g.	Foto Photo Photo	
Protezione isolante Insulating sleeves Protection isolante (1)				
NH00	NH9PN000	8	1	1
NH1	NH9PN001	10	1	1
NH2	NH9PN002	47	1	1
NH3	NH9PN003	58	1	1
Separatori Partition wall Séparateurs				
NH00	NH9SN000	18	2	1
NH1	NH9SN001	25	2	1
NH2	NH9SN002	35	2	1
NH3	NH9SN003	60	2	1
Coperchio di protezione trasparente Transparent protection cover Capot de protection transparent				
NH00	NH9CN000	8	3	1
Adattatore guida DIN Quick fixing device for DIN RAIL Adaptateur rail DIN				
NH00	NH9DN000	2	-	3
Kit unione tripolare Assembling kit for three polar Kit d'union tripolaire				
NH1 ÷ NH3	NH9UN001	33	4	1



pronta
in stock
en stock

SERIE NH
NH series | Série NH

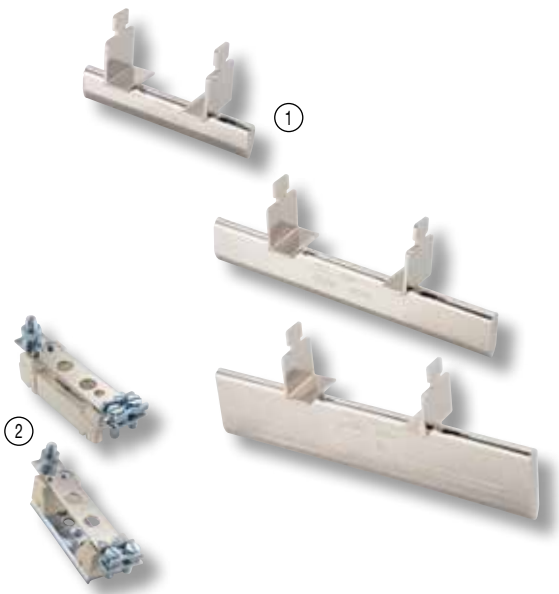

ACCESSORI
Accessories | Accessoires

i pag. 58

Grandezza Size Taille	Corrente Current Courant	Codice Code Code	Peso g. Weight Poids g.	
Trenner (1) Trenner Séparateurs				
NH00	100 A	NH9C000	82	5/60
NH0	160 A	NH9C001	115	5/40
NH1	250 A	NH9C002	137	5/40
NH2	400 A	NH9C003	208	5/40
NH3	630 A	NH9C004	294	5/40
Contatto neutro (2) Earth clamp Contact neutre				
NH00 ceramica	160 A	NH00T101	224	3/120
NH00 metallica	160 A	NH00T102	224	3/120
NH1	250 A	NH1T101	590	3/42
NH2	400 A	NH2T101	920	3/30
NH3	630 A	NH3T101	920	3/24

pronta
in stock
en stock

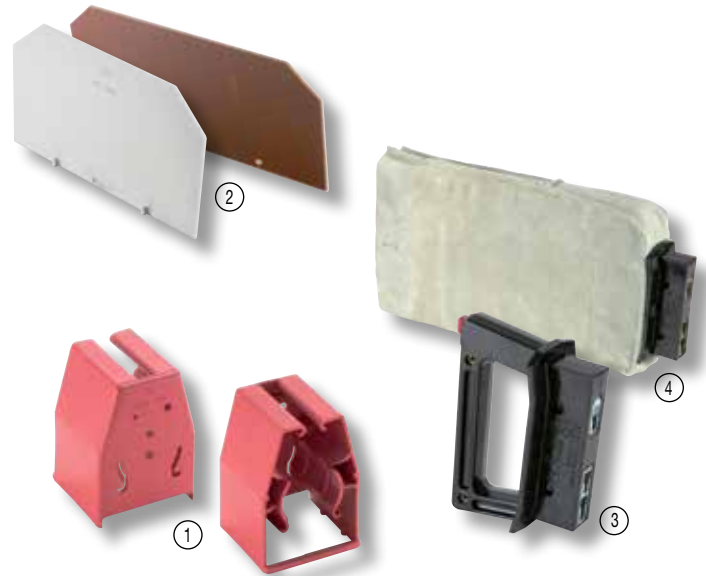

ACCESSORI
Accessories | Accessoires

Grandezza Size Taille	Codice Code Code	A A	B B	C C	Peso g. Weight Poids g.	
Protezione IP20 specifiche per basi metalliche (1) IP20 protections for metal base Protections IP20 pour bases métalliques						
NH1	NH9P001	40	52	33	13	1
NH2	NH9P002	44	63	40	19	1
NH3	NH9P003	44	67	40	19	1
Separatori specifiche per basi metalliche (2) Partition walls for metal base Séparateurs pour bases métalliques						
NH0	NH9S010	175	82	-	50	20/100
NH1	NH9S001	210	100	-	50	20/100
NH2	NH9S002	240	110	-	50	20/100
NH3	NH9S003	250	110	-	50	20/100
Maniglia (3) Handles Poignées						
NH00 ÷ NH3	NH9M001				276	1

Dimensioni | Dimensions | Dimensions

**Protezione IP20 /
IP20 protection / protection IP20**

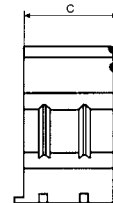
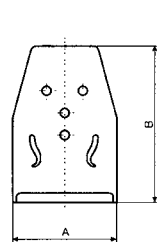

**Separatore /
partition walls / séparateur**

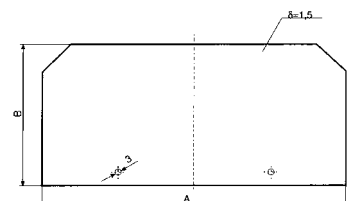

pronta
in stock
en stock



protezioni e separatori IP20: solo per basi ETI
IP20 protections and partition walls: only for ETI bases
protections IP20 et séparateurs: seulement pour bases ETI

SERIE NH

NH series | Série NH

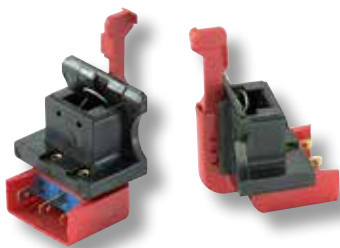

MICROCONTATTO DI MONITORAGGIO

Monitoring microcontact | *Microcontact de contrôle*

Da utilizzare su tutti i fusibili
ETI NH000 ÷ NH3

To be used with all fuses
ETI NH000 ÷ NH3

A utiliser sur tous les fusibles
ETI NH000 ÷ NH3

Codice Code Code	Peso g. Weight Poids g.
NH9S019	11,5



STRIKER E PORTASTRIKER

Strikers & strikerholders | *Striker et porte-striker*

Gli striker non sono fusibili, devono quindi essere accoppiati ad un fusibile NH, segnalandone l'avvenuta fusione. Necessitano di un collegamento parallelo e di una loro base. Sono utilizzabili in tutte le applicazioni e con tutti i tipi di fusibili NH.

Strikers are not fuses, therefore they must be coupled with a NH fuselink indicating when the blowing is accomplished. They need an in-line contact and a base. They may be used in all applications, with all types of NH fuses.

Les strikers ne sont pas des fusibles, ils doivent donc être assemblés avec un fusible NH, pour lui signaler la fusion produite. Ils ont besoin d'une liaison parallèle et d'une de leur base. On peut les utiliser pour toutes les applications et avec tous les types de fusibles NH.



pag. 58



Tensione Voltage Tension	Corrente Current Courant	Resistenza Resistance Résistance	Codice Code Code
Striker Striker Percuteur			
660 V > 9 V	2,5	2	NH9L102
690 V > 2 V	7	0,3	NH9L101
690 V	2,5	2	NH9L100

Tensione Voltage Tension	Descrizione Description Description	Codice Code Code
Porta striker Strikerholder Support de percuteur		
690 V	volante/flyer/volant	NH9L000
690 V	a base/on base/à base	NH9L001

Elegard Il sistema di monitoraggio di fusione dei fusibili ELEGARD può essere usato con ogni tipo di fusibile HRC standard non isolato 00-4. Uno striker intercambiabile è collegato elettricamente ai contatti mediante le connessioni del supporto dell'ELEGARD. Il fusibile HRC fonde da conduttore e, quando interviene, lo striker libera un pin che aziona il microinterruttore.

Elegard The Elegard blown fuse-monitoring can be used onto any standardized HRC fuse-link with live gripping lugs size 00-4. An interchangeable striker unit is electrically connected with the live gripping lugs by spring contacts of the Elegard holder. The HRC fuse-link serves as carrier and when it operates, the Elegard striker releases a pin, operating a micro switch.

Elegard Le Système de contrôle de fusion des fusibles Elegard peut être utilisé avec tous les types de fusibles HRC standards non isolés 00-4. Un percuteur interchangeable est relié électriquement aux contacts au moyen des connexions du support de l'Elegard. Le fusible HRC sert de conducteur et, quand il intervient, le percuteur libère un pin qui actionne le micro interrupteur.



a richiesta sono fornibili anche per tensioni superiori
they can be provided even for higher voltage upon request
sur demande nous pouvons les fournir aussi pour des tensions supérieures



DIMENSIONI

Dimensions | *Dimensions*

FUSIBILI NH00 gL-gG 500 V KOMBI CON DOPPIO INDICATORE

Kombi NH00 gL-gG 500 V fuses with double indicator
Fusibles NH00 gL-gG 500 V kombi avec double indicateur

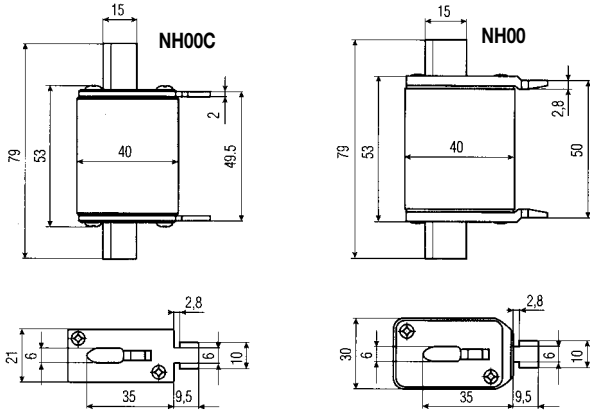

FUSIBILI NH0 gL-gG 500V KOMBI CON DOPPIO INDICATORE

Kombi NH0 gL-gG 500 V fuses with double indicator
Fusibles NH0 gL-gG 500 V kombi avec double indicateur

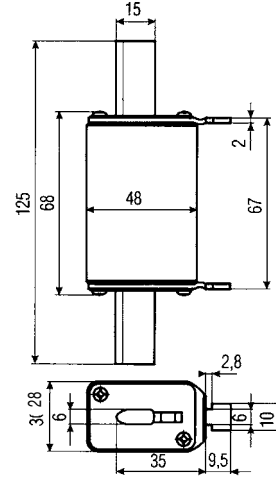

FUSIBILI NH1 gL-gG 500 V KOMBI CON DOPPIO INDICATORE

Kombi NH1 gL-gG 500 V fuses with double indicator
Fusibles NH1 gL-gG 500 V kombi avec double indicateur

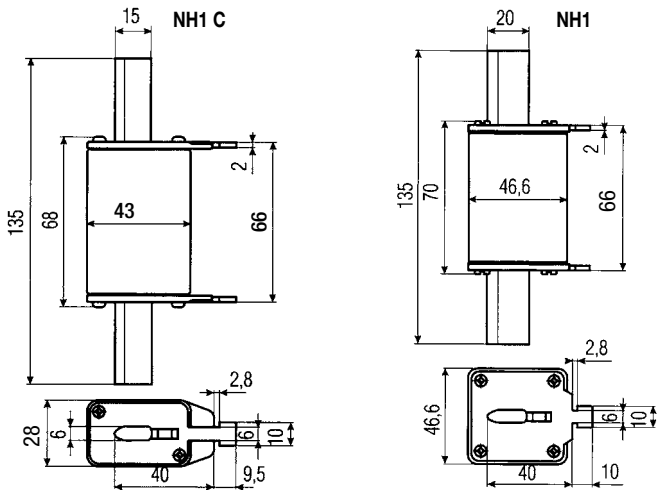

FUSIBILI NH2 gL-gG 500 V KOMBI CON DOPPIO INDICATORE

Kombi NH2 gL-gG 500 V fuses with double indicator
Fusibles NH2 gL-gG 500 V kombi avec double indicateur

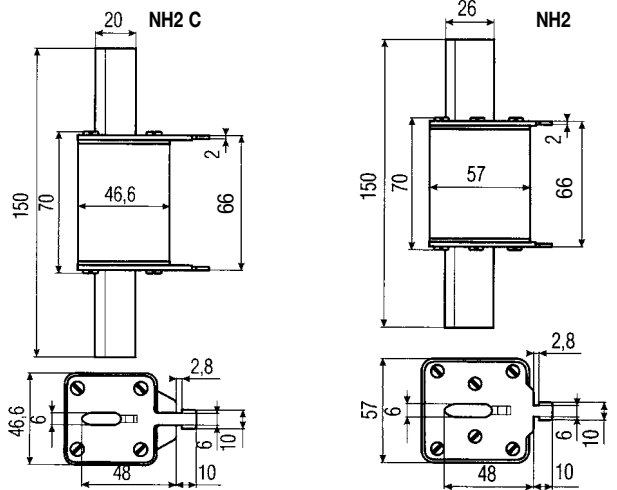

FUSIBILI NH3 gL-gG 500 V KOMBI CON DOPPIO INDICATORE

Kombi NH3 gL-gG 500 V fuses with double indicator
Fusibles NH3 gL-gG 500 V kombi avec double indicateur

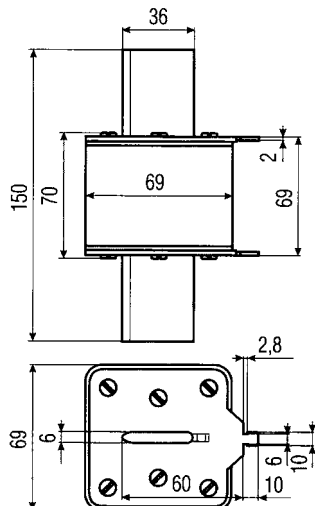

FUSIBILI NH4 e NH4a gL - gG 500 V

NH4 and NH4a gL - gG 500 V fuses | Fusibles NH4 et NH4a gL - gG 500 V

Dimensioni | Dimensions | Dimensions

Modello Model Modèle	A	B	C	D	E	F	G	H	I	J	K
NH4	200	75	66	87	50	100	121	24	150	16	8
NH4a	200	99	87	85	50	95	121	27			6

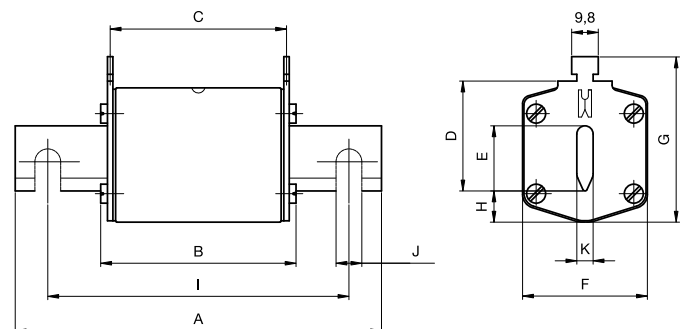

DIMENSIONI

Dimensions | Dimensions

FUSIBILI NH00 gL-gG 690 V KOMBI CON DOPPIO INDICATORE

Kombi NH00 gL-gG 690 V fuses with double indicator
Fusibles NH00 gL-gG 690 V kombi avec double indicateur

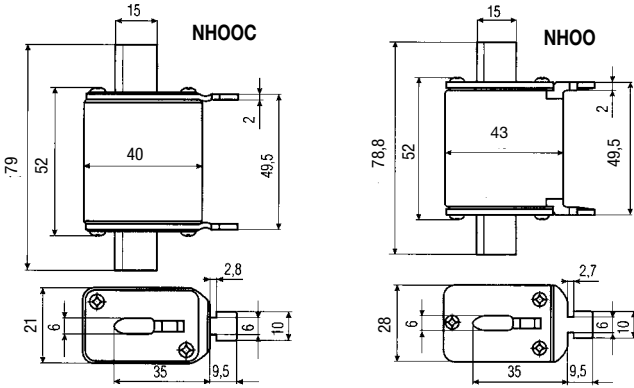

FUSIBILI NH0 gL-gG 690 V KOMBI CON DOPPIO INDICATORE

Kombi NH0 gL-gG 690 V fuses with double indicator
Fusibles NH0 gL-gG 690 V kombi avec double indicateur

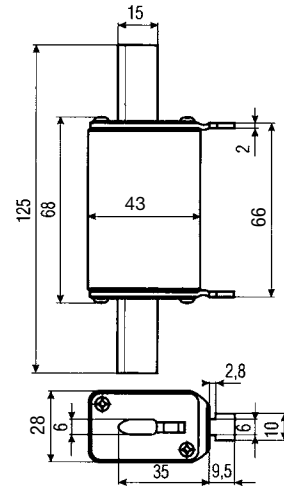

FUSIBILI NH1 gL-gG 690 V KOMBI CON DOPPIO INDICATORE

Kombi NH1 gL-gG 690 V fuses with double indicator
Fusibles NH1 gL-gG 690 V kombi avec double indicateur

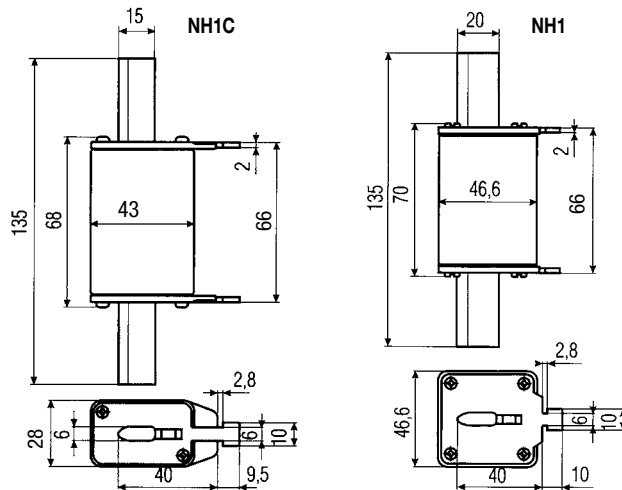

FUSIBILI NH1 gL - gG 1000 V

NH1 gL - gG 1000 V fuses | Fusibles NH1 gL - gG 1000V

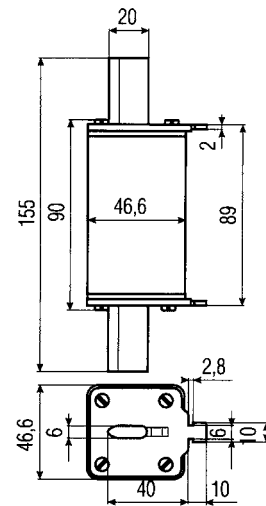

FUSIBILI NH2 gL-gG 690 V KOMBI CON DOPPIO INDICATORE

Kombi NH2 gL-gG 690 V fuses with double indicator
Fusibles NH2 gL-gG 690 V kombi avec double indicateur

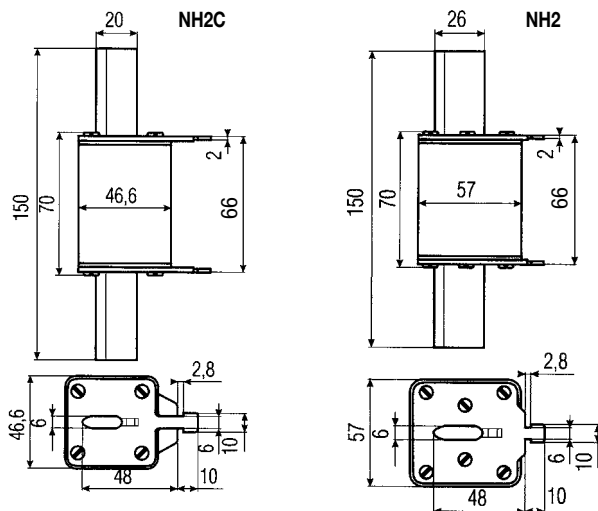

FUSIBILI NH3 gL-gG 690 V KOMBI CON DOPPIO INDICATORE

Kombi NH3 gL-gG 690 V fuses with double indicator
Fusibles NH3 gL-gG 690 V kombi avec double indicateur

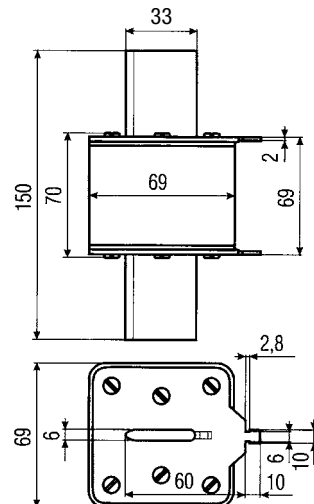

DIMENSIONI

Dimensions | *Dimensions*

FUSIBILI NH00 aM NH00 aM fuses | *Fusibles NH00 aM*

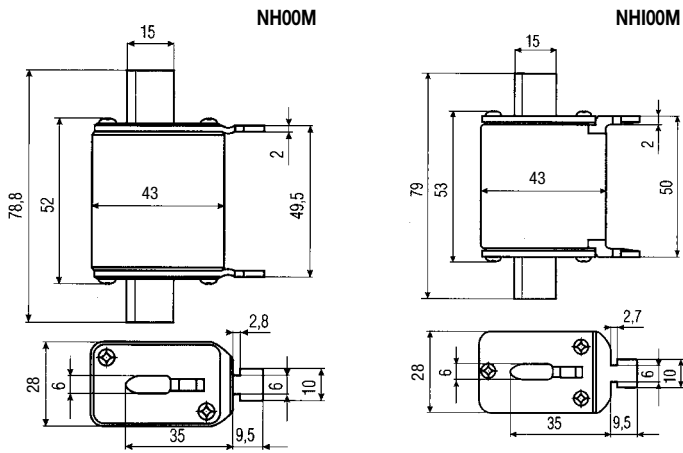

FUSIBILI NH0 aM NH0 aM fuses | *Fusibles NH0 aM*

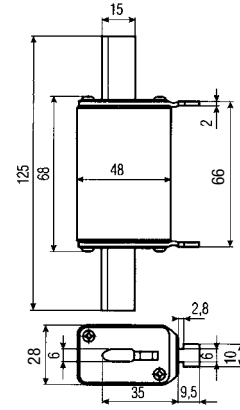

FUSIBILI NH1 aM NH1 aM fuses | *Fusibles NH1 aM*

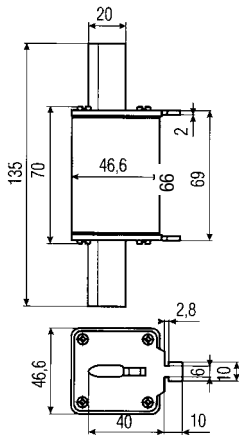

FUSIBILI NH2 aM - NH3 aM NH2 aM - NH3 aM fuses | *Fusibles NH2 aM - NH3 aM*

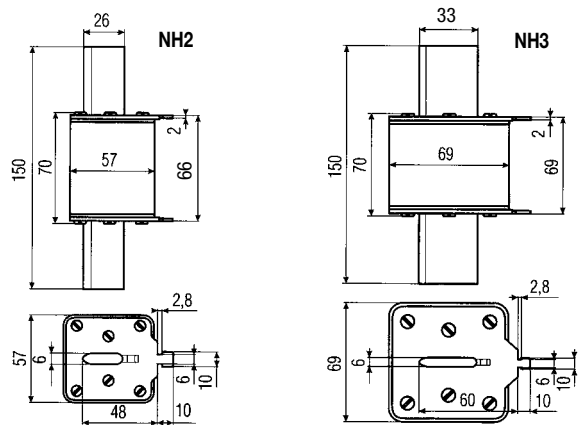

DIMENSIONI

Dimensions | *Dimensions*

DIAGRAMMA DI INTERVENTO DEI FUSIBILI gL - gG 500 V

Diagram of Cut-Off current of HRC gL - gG fuse links 500 V
Diagramme d'intervention des fusibles gL - gG 500 V

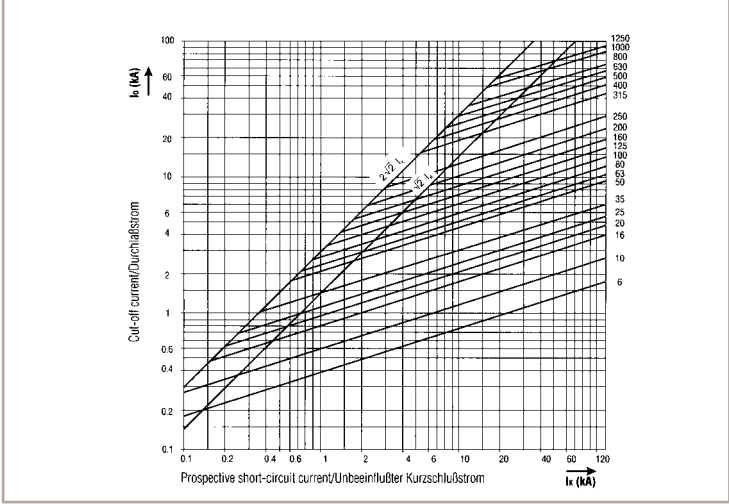

CURVE TEMPO/CORRENTE DEI FUSIBILI gL - gG 500 V - 660/690 V - 1000 V

Time/current characteristics of HRC gL - gG fuse links 500V - 660/690 V - 1000 V
Courbes temps/courant des fusibles gL - gG 500 V - 660/690 V - 1000 V



DIAGRAMMA DI INTERVENTO DEI FUSIBILI gL - gG 660/690 V

Diagram of Cut-Off current of HRC gL - gG fuse links 660/690 V
Diagramme d'intervention des fusibles gL - gG 660/690 V

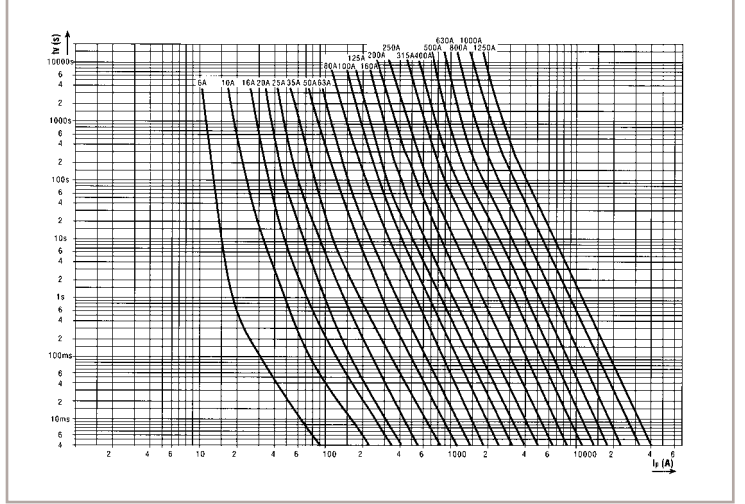
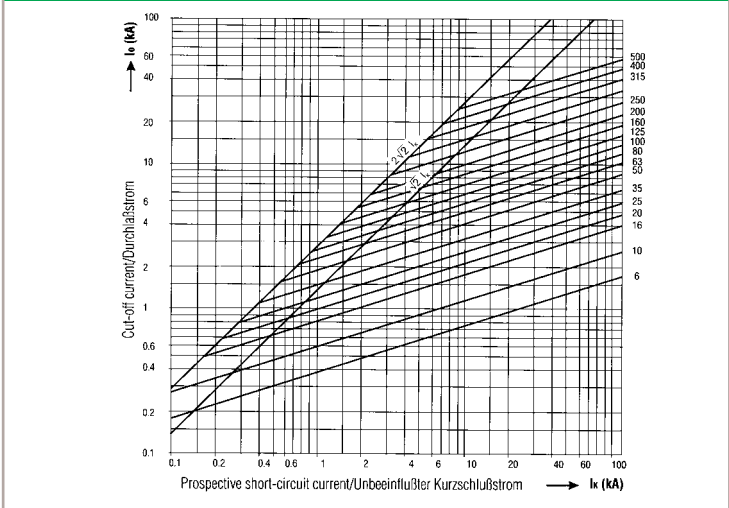

CURVE TEMPO/CORRENTE DEI FUSIBILI aM 690 V

Time/current characteristics of HRC aM fuse links 690 V
Courbes temps/courant des fusibles aM 690 V

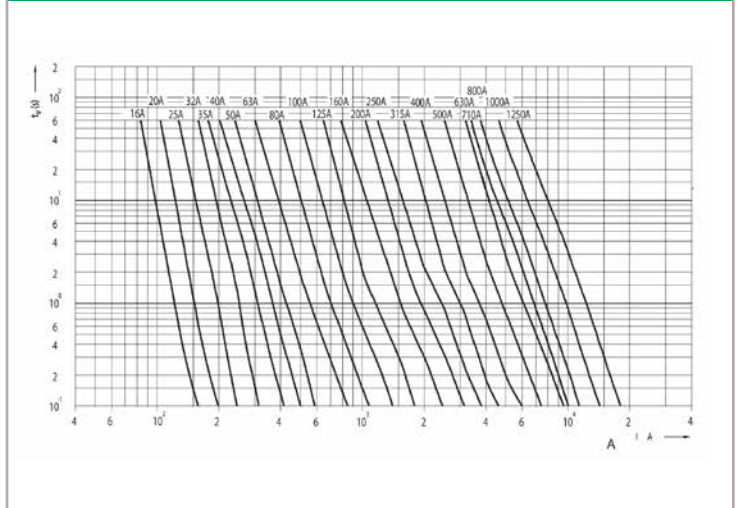

CURVE TEMPO/CORRENTE

Time/current characteristic | *Courbes temps/courant*

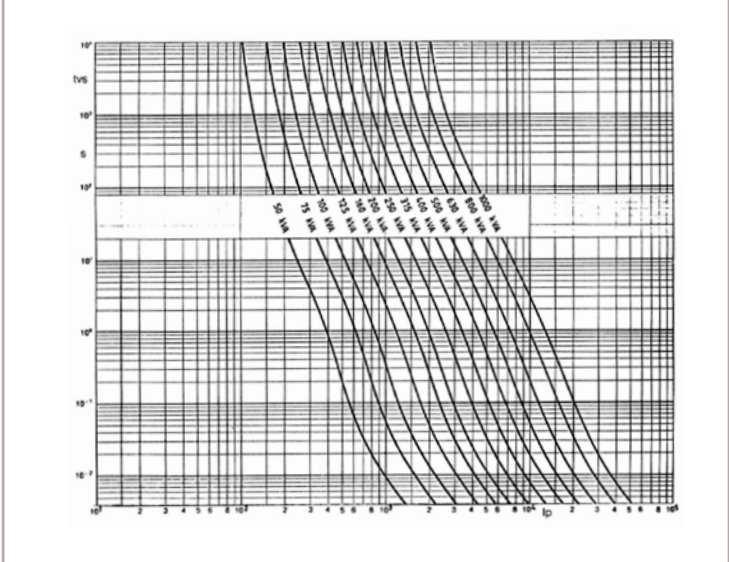

CARATTERISTICHE DI FUSIONE

Cut-off characteristics | *Caractéristiques de fusion*

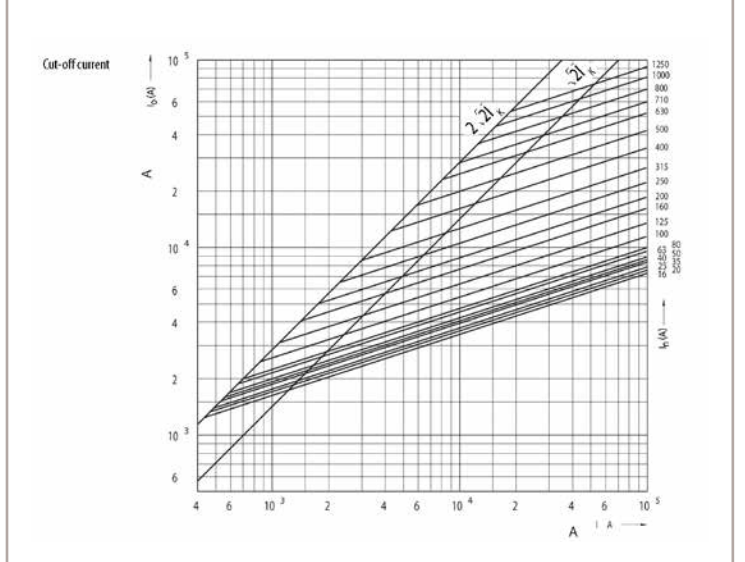

CARATTERISTICHE DI FUSIONE

NH fuses time current characteristics | *Caractéristiques de fusion fusibles NH*

ACCESSORI

Accessories | *Accessoires*

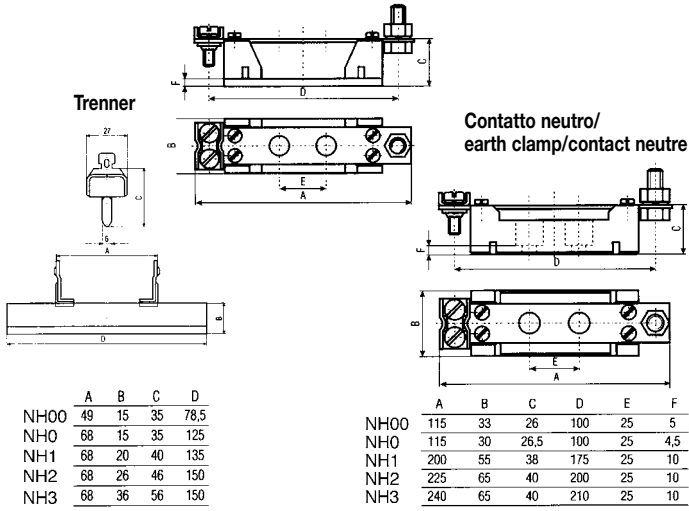

STRIKER E PORTASTRIKER

Striker and strikerholder | *Percuteur et support de percuteur*

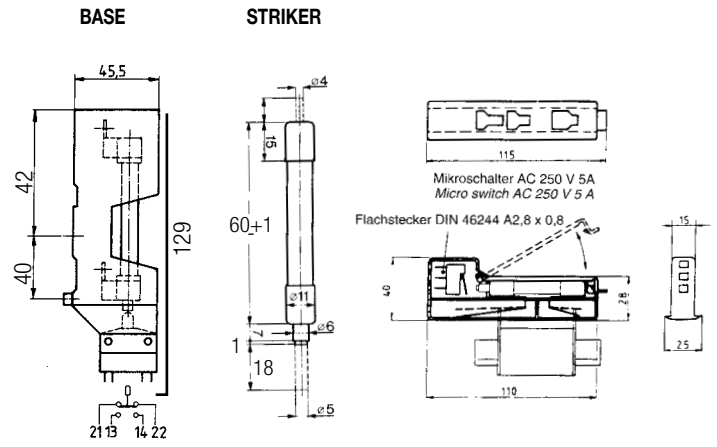

BASE NH TERMOPLASTICA

NH thermoplastic base | *Base NH thermoplastique*

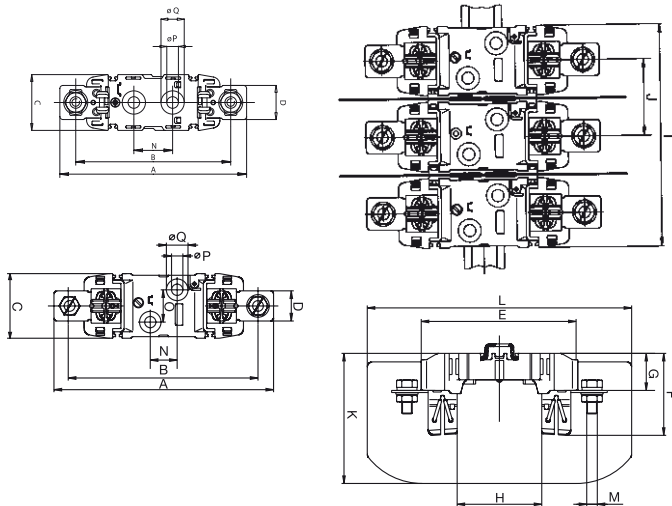

	grandezza -size				
	NH-00	NH-0	NH-1	NH-2	NH-3
A	120	170	200	225	240
B	100	150	175	200	210
C	37	47	60	60	60
D	20	24	28	32	38
E	86	122	148	148	148
F	58	63	77,5	88	97
G	23	29	35	35	35
H	56,5	74	80	80	80
I	114	144	192	192	224
J	38,5	48,5	66	66	82
K	84,5	91,5	123	123	143
L	146	185	250	250	270
M	M8	M8	M10	M12	M12
N	25	25	25	25	25
O	0	0	30	30	30
P	15	15	10,5	10,5	10,5
Q	7,5	7,5	20,5	20,5	20,5

BASE NH METALLICA

NH metal base | *Base NH métallique*

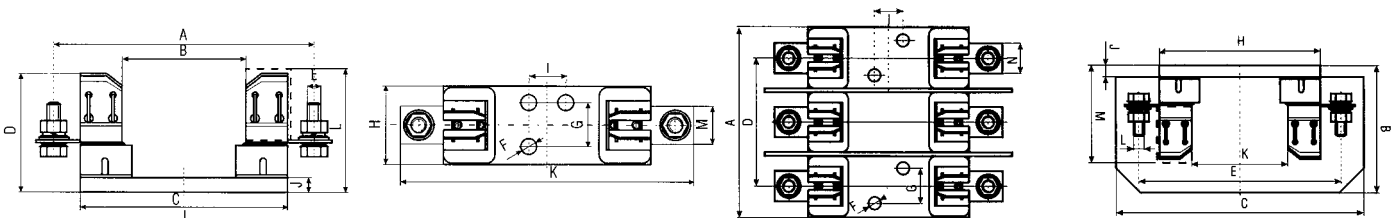

DIMENSIONI BASI NH

N° POLI	METALLICA															
	A	B	B ₂	C	D	E	F	G	H	I	J	K	L	L ₂	M	N
NH00B100	1	100	57	84	80	M8-2M6	ø 7,5				25	4,5	115			20
NH00B101	1	100	57	84	80	M8-M8	ø 7,5				25	4,5	115			20
NH0B101	1	150	74	130	80	M8-M8	ø 7,5			33	25	4,5	170			20
NH1B101	1	175	80	141	81	M10	ø10,5	30		55	25	10	200			26
NH1B102	1	193	100	160	81	M10	ø10,5	30		55	25	10	220			26
NH2B101	1	200	80	166	102	M10	ø10,5	30		65	25	10	225			30
NH3B101	1	210	80	166	102	M12	ø10,5	30		65	25	10	240			30
NH4B101	1	270	100	220	143	M12	ø 13	30		102	25	12	310			50
NH00B301	3	96	91,5	125	61	100	ø 7,5			84	25	4,5	57	M8-M8		20
NH0B301	3	104	91,5	175	70	150	ø 7,5			130	25	4,5	74	M8-M8		20
NH1B301	3	160	110	210	106	175	ø10,5	30		141	25	10	80	M10		26
NH2B301	3	184	120	240	122,5	200	ø10,5	30		166	25	10	80	M10		30
NH3B301	3	208	120	240	148	210	ø10,5	30		166	25	10	80	M12		30

DIMENSIONI

Dimensions | Dimensions

BASI NH TERMOPLASTICHE COMPONIBILI Modular NH thermoplastic base | Bases NH thermoplastique modulaires

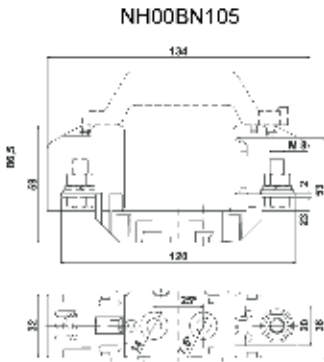

NH1BN105 - NH2BN105 - NH3BN105

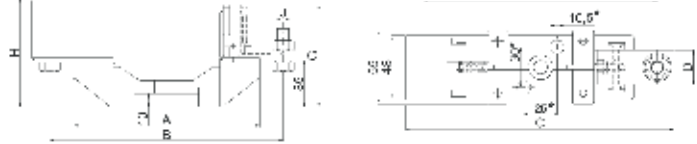

dimensions are in mm

Type	A	B	C	D	E	F	G	H	I	J
NH1BN105	140	175	200	25	-	-	76	82	-	M10
NH2BN105	154	200	230	30	-	-	83	87	-	M10
NH3BN105	164	210	250	30	-	-	91	95	-	M12

ACCESSORI PER BASE NH TERMOPLASTICA COMPONIBILE Accessories for modular NH thermoplastic base | Accessoires pour base NH thermoplastique

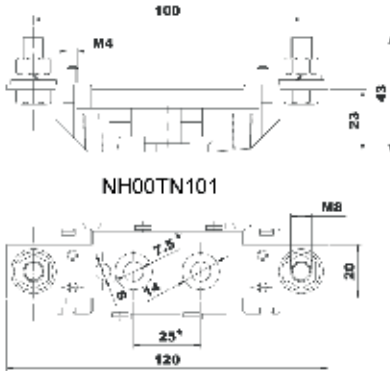

CONTATTO NEUTRO
Earth clamp

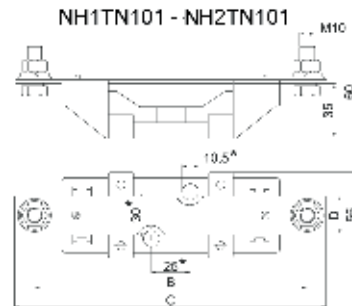

	NH1TN101	NH2TN101
B	175.5	200
C	200	230
D	25	30

BASI NH00-NH1-NH2-NH3 TERMOPLASTICHE Modular NH00-NH1-NH2-NH3 thermoplastic bases | Bases NH00-NH1-NH2-NH3 thermoplastiques modulaires

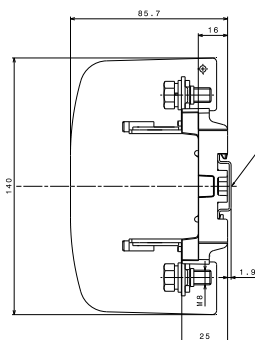
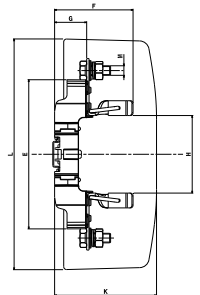
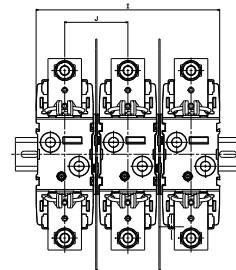
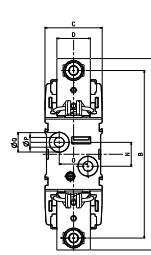
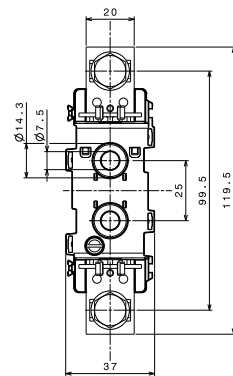
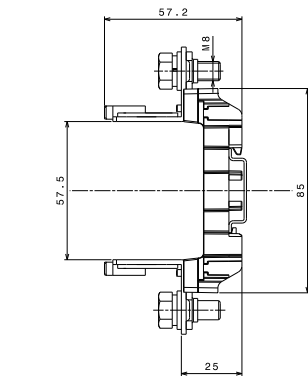

RA1L 35x7.5mm
SECONDO LA NORMA EN 50022
ACCORDING TO STANDARD EN 50022

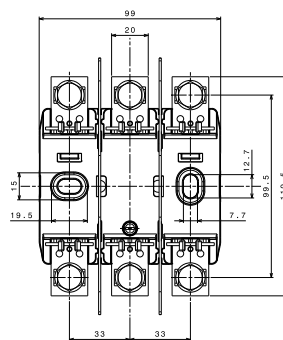

(mm)	NH-1	NH-2	NH-3
A	200	225	240
B	175	200	210
C	60	60	60
D	35	35	35
E	156	156	156
F	82	88	99
G	33.5	33.5	33.5
H	81	81	81
I	192	192	224
J	66	66	82
K	107	115	129
L	241	266	268
M	M10	M10	M12
N	25	25	25
O	30	30	30
P	10.5	10.5	10.5
Q	20.5	20.5	20.5